

W2G107-AD01-13 ebmpapst Datasheet

sales@fansco.com

www.fansco.com

**Nominal data**

<b>Type</b>	<b>W2G107-AD01-13</b>	
<b>Motor</b>	<b>M2G045-BA</b>	
Nominal voltage	VDC	12
Nominal voltage range	VDC	8 .. 16
Type of data definition		fa
Speed	min <sup>-1</sup>	2800
Power input	W	3.5
Min. ambient temperature	°C	-25
Max. ambient temperature	°C	+72

ml = max. load · me = max. efficiency · fa = running at free air · cs = customer specs · cu = customer unit  
Subject to alterations



### Technical features

<b>Mass</b>	0.6 kg
<b>Size</b>	107 mm
<b>Material of blades</b>	Sheet steel, coated in black
<b>Material of wall ring</b>	Die-cast aluminium, coated in black
<b>Number of blades</b>	5
<b>Direction of air flow</b>	"V"
<b>Direction of rotation</b>	Counter-clockwise, seen on rotor
<b>Type of protection</b>	IP 22
<b>Insulation class</b>	"B"
<b>Max. permissible ambient motor temp. (transp./ storage)</b>	+ 80 °C
<b>Min. permissible ambient motor temp. (transp./storage)</b>	- 25 °C
<b>Mounting position</b>	Any
<b>Condensate discharge holes</b>	None
<b>Operation mode</b>	S1
<b>Motor bearing</b>	Ball bearing
<b>Electrical leads</b>	With plug
<b>Motor protection</b>	Reverse polarity and locked-rotor protection
<b>Approval</b>	UL 507; CSA C22.2 Nr.113



## Product drawing

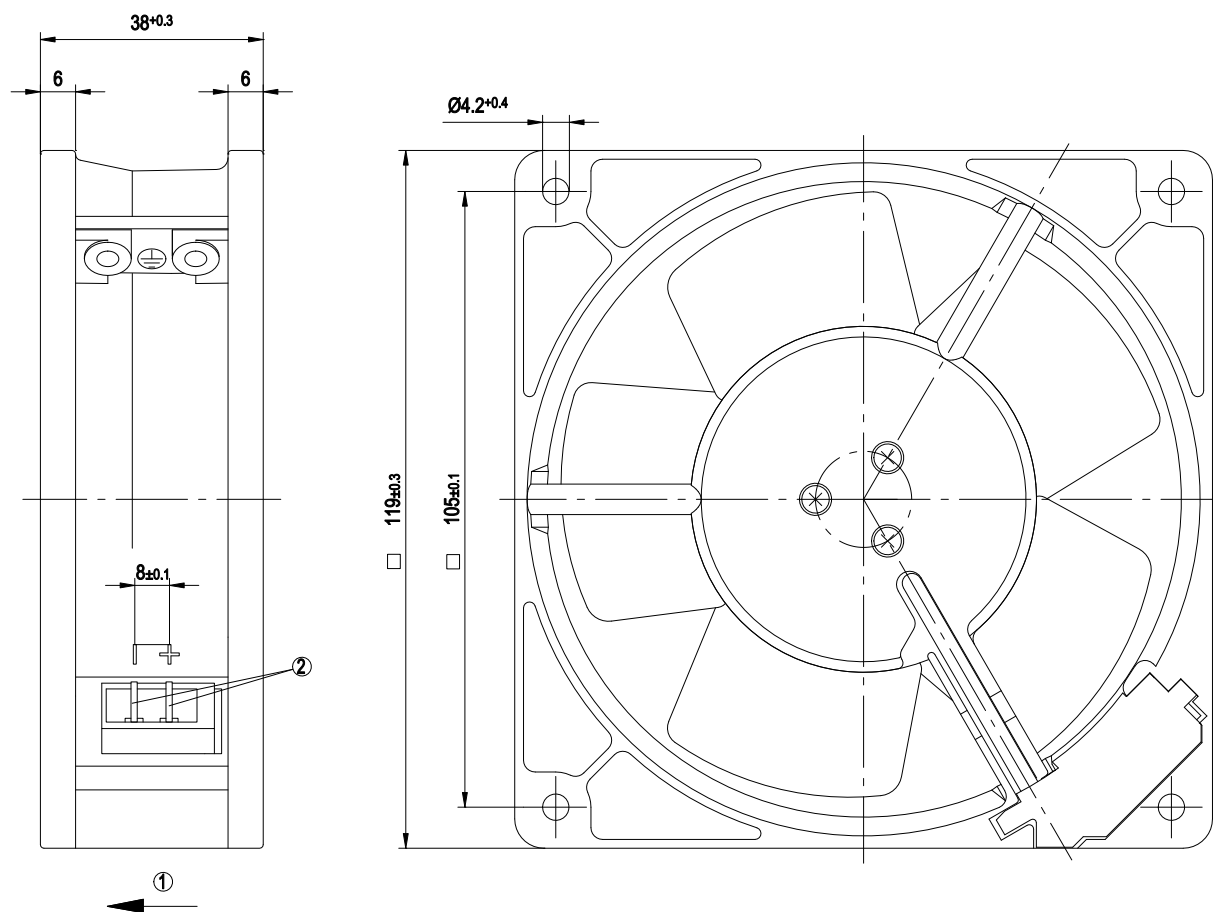

- |   |   |
|---|---|
| 1 | Direction of air flow "V"                 |
| 2 | 2 x flat plugs 2.8x0.5 (AMP no. 170058-2) |

## Connection screen

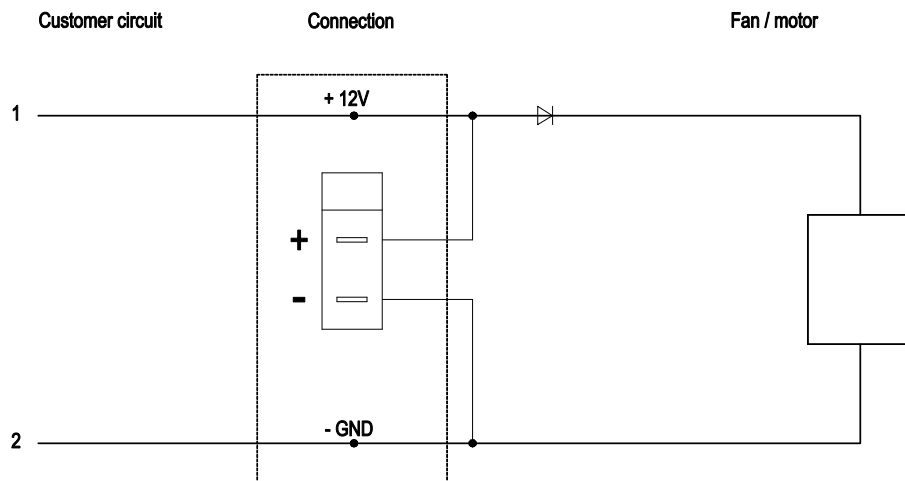

Line	No.	Signal	Colour	Function / assignment
1	1	UN +12V	red	Power supply +12 V/voltage range refer to rating plate, residual ripple $\pm 3.5\%$
1	2	GND	blue	Reference mass

## Charts: Air flow

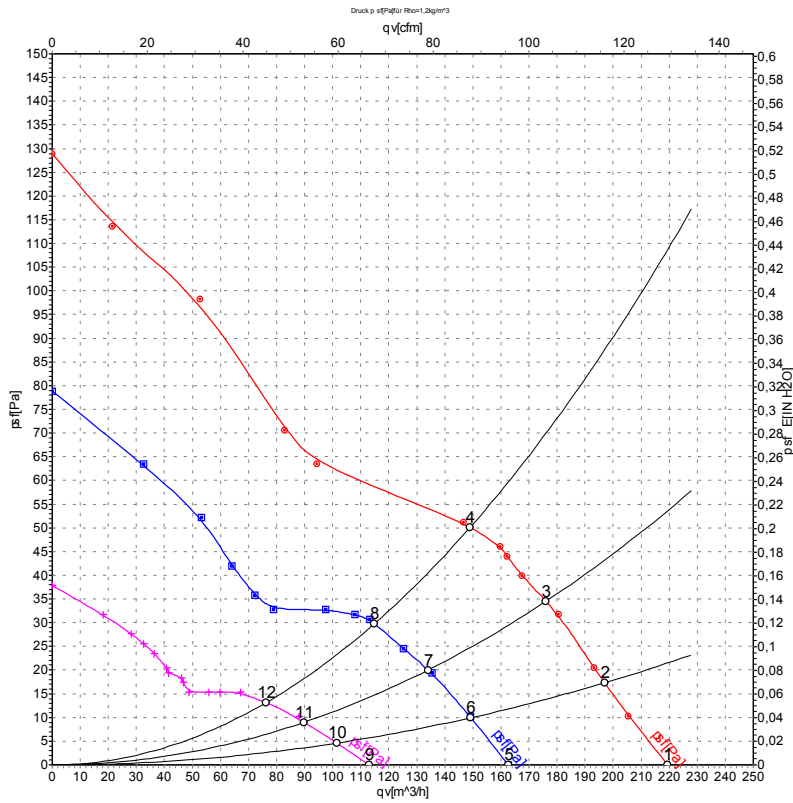

Measurement: LU-9328  
 Measurement: LU-9326  
 Measurement: LU-9327

Air performance measured as per ISO 5801 Installation category A. For detailed information on the measuring set-up, please contact ebmpapst. Suction-side noise levels: L<sub>wA</sub> measured as per ISO 13347 / L<sub>pA</sub> measured with 1m distance to fan axis. The values given are valid under the measuring conditions mentioned above and may vary according to the actual installation situation. With any deviation from the standard set-up, the specific values have to be checked and reviewed with the unit installed.

## Measured values

	U	n	P <sub>e</sub>	I	qv	p <sub>sf</sub>
	V	min <sup>-1</sup>	W	A	m <sup>3</sup> /h	Pa
1	16	3800	7.0	0.44	220	0
2	16	3690	7.3	0.46	195	17
3	16	3600	7.7	0.49	175	35
4	16	3520	8.1	0.50	150	50
5	12	2875	3.5	0.29	165	0
6	12	2815	3.7	0.31	150	10
7	12	2755	4.0	0.34	135	20
8	12	2715	4.3	0.36	115	30
9	8	1900	1.40	0.17	115	0
10	8	1860	1.49	0.19	100	5
11	8	1820	1.59	0.20	90	10
12	8	1800	1.60	0.20	75	13

