

R4E355-RM03-03 ebmpapst Datasheet

sales@fansco.com

www.fansco.com

Nominal data

| | | | |
|-------------------------------|-------------------|---------|---------|
| Type | R4E355-RM03-03 | | |
| Motor | M4E094-EA | | |
| Phase | | 1~ | 1~ |
| Nominal voltage | VAC | 230 | 230 |
| Frequency | Hz | 50 | 60 |
| Type of data definition | | ml | ml |
| Valid for approval / standard | | CE | CE |
| Speed | min ⁻¹ | 1370 | 1520 |
| Power input | W | 280 | 400 |
| Current draw | A | 1.23 | 1.77 |
| Motor capacitor | μF | 8 | 8 |
| Capacitor voltage | VDB | 400 | 400 |
| Capacitor standard | | P0 (CE) | P0 (CE) |
| Min. back pressure | Pa | 0 | 0 |
| Min. ambient temperature | °C | -40 | -40 |
| Max. ambient temperature | °C | 55 | 60 |
| Starting current | A | 2.75 | 2.1 |

ml = max. load · me = max. efficiency · fa = running at free air · cs = customer specs · cu = customer unit
Subject to alterations

Data according to ErP directive

| | | Actual | Request 2013 | Request 2015 |
|--------------------------------|-------------------|--------|--------------|--------------|
| Installation category | A | | | |
| Efficiency category | Static | | | |
| Variable speed drive | No | | | |
| Specific ratio* | 1.00 | | | |
| Overall efficiency η_{es} | | 45.5 | 41.5 | 45.5 |
| Efficiency grade N | | 62 | 58 | 62 |
| Power input P_e | kW | 0.27 | | |
| Air flow q_v | m ³ /h | 2005 | | |
| Pressure increase p_{fs} | Pa | 224 | | |
| Speed n | min ⁻¹ | 1370 | | |

Data established at point of optimum efficiency

* Specific ratio = $1 + p_b / 100\,000\text{ Pa}$ 

Technical features

| | |
|--|---|
| Mass | 6 kg |
| Size | 355 mm |
| Surface of rotor | Coated in black |
| Material of impeller | PP plastic |
| Number of blades | 6 |
| Direction of rotation | Clockwise, seen on rotor |
| Type of protection | IP 54 |
| Insulation class | "F" |
| Humidity class | F4-1 |
| Max. permissible ambient motor temp. (transp./ storage) | + 80 °C |
| Min. permissible ambient motor temp. (transp./storage) | - 40 °C |
| Mounting position | Any |
| Condensate discharge holes | None |
| Operation mode | S1 |
| Motor bearing | Ball bearing |
| Touch current acc. IEC 60990 (measuring network Fig. 4, TN system) | <= 3.5 mA |
| Motor protection | Thermal overload protector (TOP) wired internally |
| Cable exit | Variable |
| Protection class | I (if protective earth is connected by customer) |
| Product conforming to standard | CE |

Product drawing

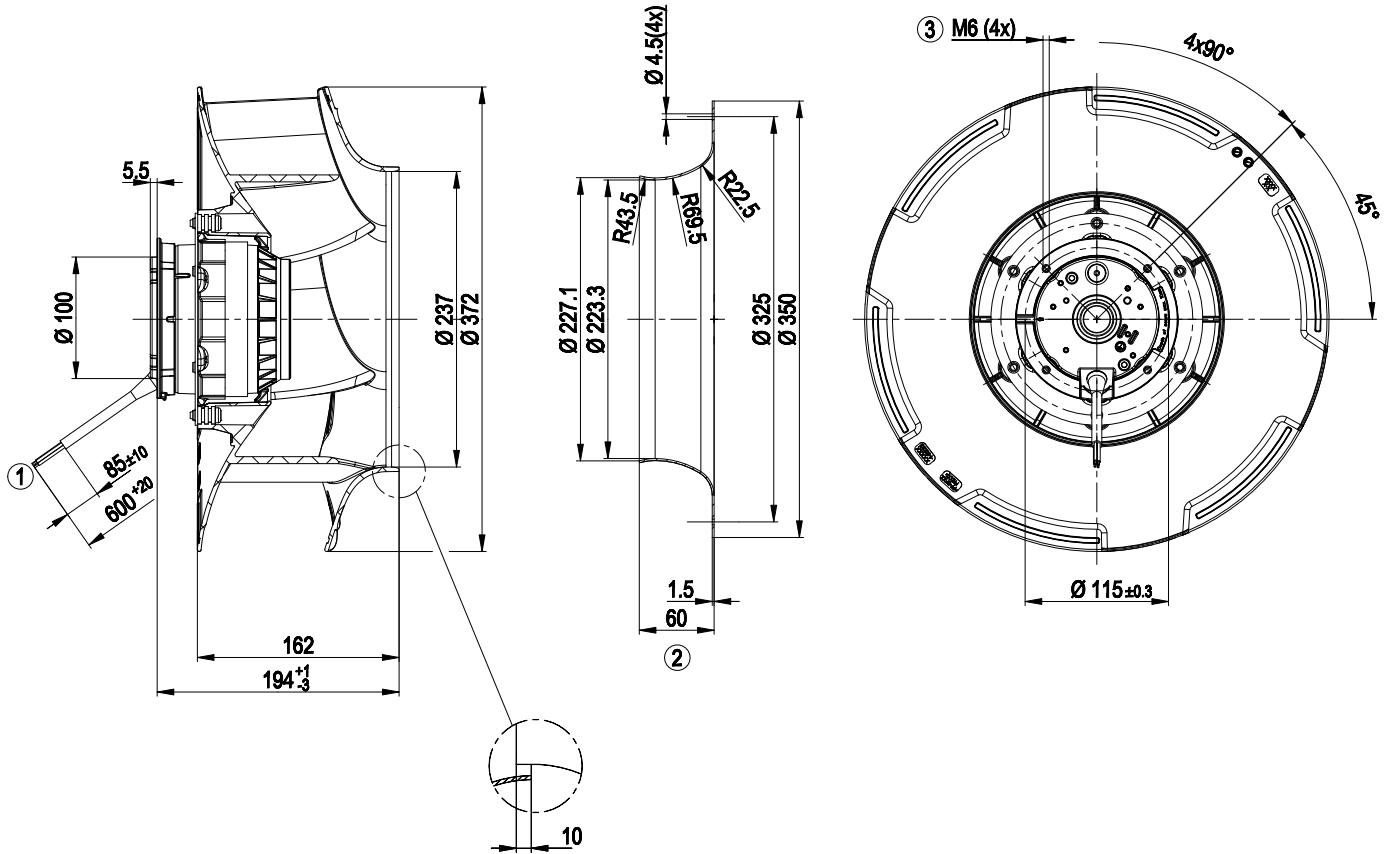

- 2 Connection line silicone 4G 0.5 mm², 4 x brass lead tips crimped
- 3 Accessory part: Inlet nozzle 35500-2-4013, not included in the standard scope of delivery
- 4 Depth of screw max. 10 mm

Connection screen

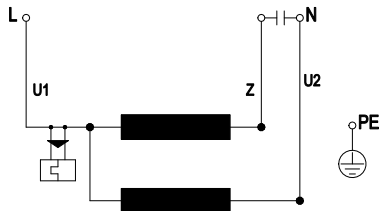

| | | | | | |
|----|--------------|---|-------|----|-------|
| U1 | blue | Z | brown | U2 | black |
| PE | green/yellow | | | | |

Charts: Air flow 50 Hz

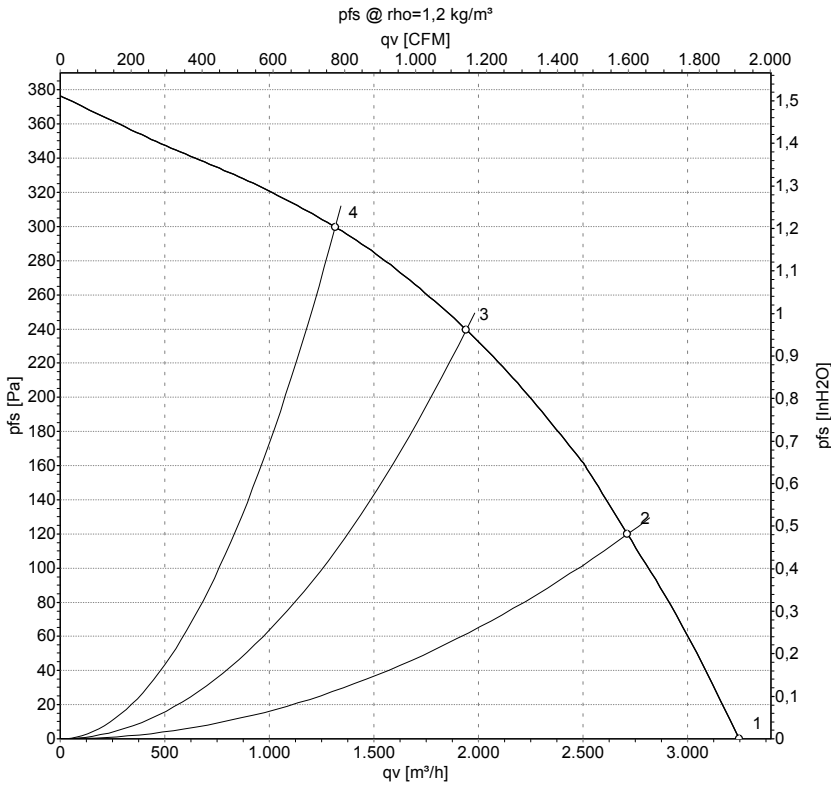

Measurement: LU-144684

Air performance measured as per ISO 5801 Installation category A. For detailed information on the measuring set-up, please contact ebm-papst. Suction-side noise levels: LwA measured as per ISO 13347 / LpA measured with 1m distance to fan axis. The values given are valid under the measuring conditions mentioned above and may vary according to the actual installation situation. With any deviation from the standard set-up, the specific values have to be checked and reviewed with the unit installed.

Measured values

| | U | f | n | P _e | I | LpA _{in} | LwA _{in} | qv | p _{fs} |
|---|-----|----|-------------------|----------------|------|-------------------|-------------------|-------------------|-----------------|
| | V | Hz | min ⁻¹ | W | A | dB(A) | dB(A) | m ³ /h | Pa |
| 1 | 230 | 50 | 1410 | 225 | 1.02 | 64 | 71 | 3245 | 0 |
| 2 | 230 | 50 | 1390 | 254 | 1.13 | 59 | 66 | 2715 | 120 |
| 3 | 230 | 50 | 1370 | 280 | 1.23 | 57 | 63 | 1940 | 240 |
| 4 | 230 | 50 | 1380 | 264 | 1.17 | 58 | 65 | 1315 | 300 |

U = Supply voltage · f = Frequency · n = Speed · P_e = Power input · I = Current draw · LpA_{in} = Sound pressure level inlet side · LwA_{in} = Sound power level inlet side · qv = Air flow
 p_{fs} = Pressure increase



Charts: Air flow 60 Hz

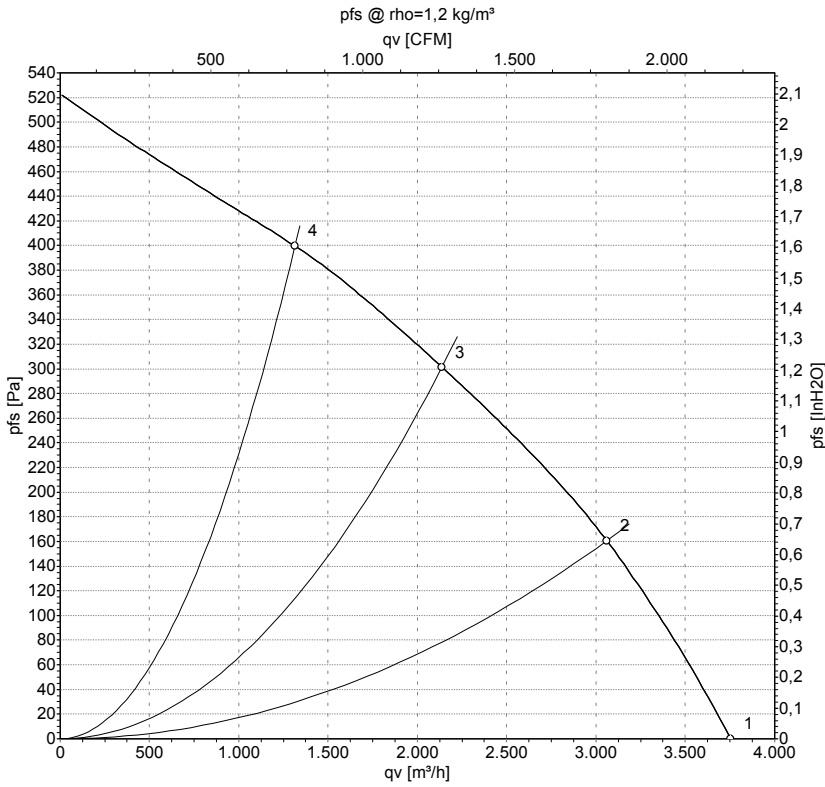

Measurement: LU-144692

Air performance measured as per ISO 5801 Installation category A. For detailed information on the measuring set-up, please contact ebm-papst. Suction-side noise levels: LwA measured as per ISO 13347 / LpA measured with 1m distance to fan axis. The values given are valid under the measuring conditions mentioned above and may vary according to the actual installation situation. With any deviation from the standard set-up, the specific values have to be checked and reviewed with the unit installed.

Measured values

| | U | f | n | P _e | I | LpA _{in} | LwA _{in} | qv | p _{fs} |
|---|-----|----|-------------------|----------------|------|-------------------|-------------------|------|-----------------|
| | V | Hz | min ⁻¹ | W | A | dB(A) | dB(A) | m³/h | Pa |
| 1 | 230 | 60 | 1635 | 331 | 1.48 | 67 | 75 | 3755 | 0 |
| 2 | 230 | 60 | 1570 | 377 | 1.66 | 62 | 69 | 3060 | 160 |
| 3 | 230 | 60 | 1520 | 400 | 1.77 | 59 | 66 | 2135 | 300 |
| 4 | 230 | 60 | 1570 | 379 | 1.67 | 63 | 70 | 1315 | 400 |

U = Supply voltage · f = Frequency · n = Speed · P_e = Power input · I = Current draw · LpA_{in} = Sound pressure level inlet side · LwA_{in} = Sound power level inlet side · qv = Air flow
p_{fs} = Pressure increase

