

R3G400-AD11-15

EC centrifugal fan

backward-curved, single-intake



R3G400-AD11-15 ebmpapst Datasheet

sales@fansco.com

www.fansco.com

Limited partnership · Headquarters Muldingen

Amtsgericht (court of registration) Stuttgart · HRA 590344

General partner Elektrobau Muldingen GmbH · Headquarters Muldingen

Amtsgericht (court of registration) Stuttgart · HRB 590142

Nominal data

Type	R3G400-AD11-15	
Motor	M3G084-FA	
Nominal voltage	VDC	24
Nominal voltage range	VDC	16 .. 28
Method of obtaining data		fa
Speed (rpm)	min ⁻¹	1450
Power consumption	W	300
Current draw	A	13
Min. ambient temperature	°C	-25
Max. ambient temperature	°C	45

ml = Max. load · me = Max. efficiency · fa = Free air · cs = Customer specification · ce = Customer equipment
Subject to change

Data according to Commission Regulation (EU) 327/2011

		Actual	Req. 2015
01 Overall efficiency η_{es}	%	59	46
02 Measurement category		A	
03 Efficiency category		Static	
04 Efficiency grade N		75	62
05 Variable speed drive		Yes	

Data obtained at optimum efficiency level.
The ErP data is determined using a motor-impeller combination in a standardized measurement setup.

09 Power consumption P_e	kW	0.3
09 Air flow q_v	m ³ /h	1635
09 Pressure increase p_{fs}	Pa	350
10 Speed (rpm) n	min ⁻¹	1370
11 Specific ratio*		1.00

* Specific ratio = $1 + p_{fs} / 100\,000\text{ Pa}$

LU-58922



Technical description

Weight	5.2 kg
Fan size	400 mm
Rotor surface	Painted black
Electronics housing material	Die-cast aluminum
Impeller material	Sheet aluminum
Number of blades	6
Direction of rotation	Clockwise, viewed toward rotor
Degree of protection	IP20
Insulation class	"B"
Moisture (F) / Environmental (H) protection class	H1
Max. permitted ambient temp. for motor (transport/storage)	+80 °C
Min. permitted ambient temp. for motor (transport/storage)	-40 °C
Installation position	Shaft horizontal or rotor on bottom; rotor on top on request
Condensation drainage holes	None
Cooling hole/opening	On rotor side
Mode	S1
Motor bearing	Ball bearing
Technical features	<ul style="list-style-type: none"> - Tach output - Motor current limitation - Soft start - Control input 0-10 VDC / PWM - Thermal overload protection for motor
EMC immunity to interference	According to EN 61000-6-2 (industrial environment)
EMC interference emission	According to EN 55022 (Class B, household environment)
Motor protection	Thermal overload protector (TOP) internally connected
With cable	Variable
Conformity with standards	EN 60950-1; CE
Approval	CSA C22.2 No. 100; UL 1004-1

Product drawing

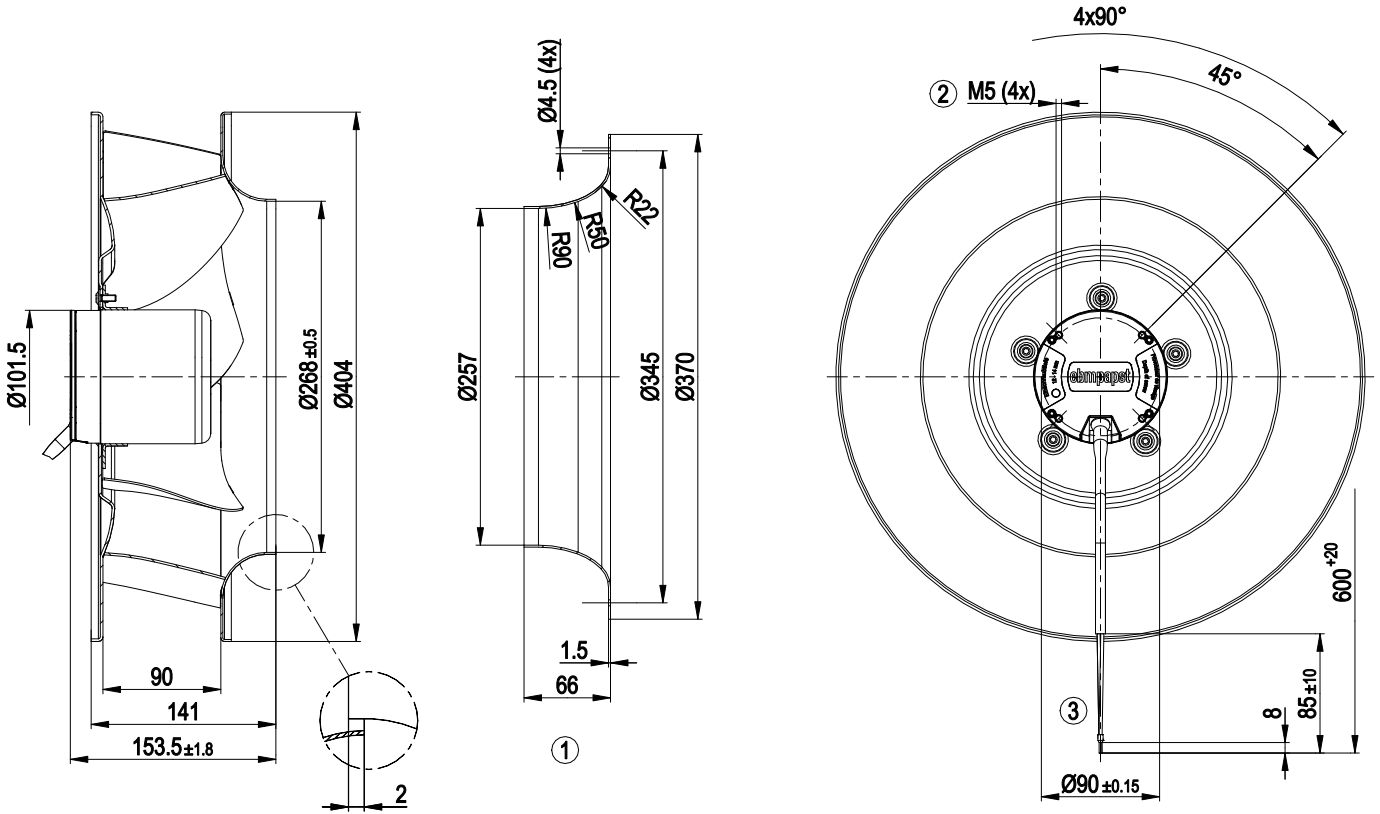

- | | |
|---|---|
| 1 | Accessory part: inlet ring 54476-2-4013 not included in scope of delivery |
| 2 | Max. clearance for screw 14 mm |
| 3 | Cable PVC AWG16, 4x crimped ferrules |



Connection diagram

Customer circuit

Application instructions for various control options

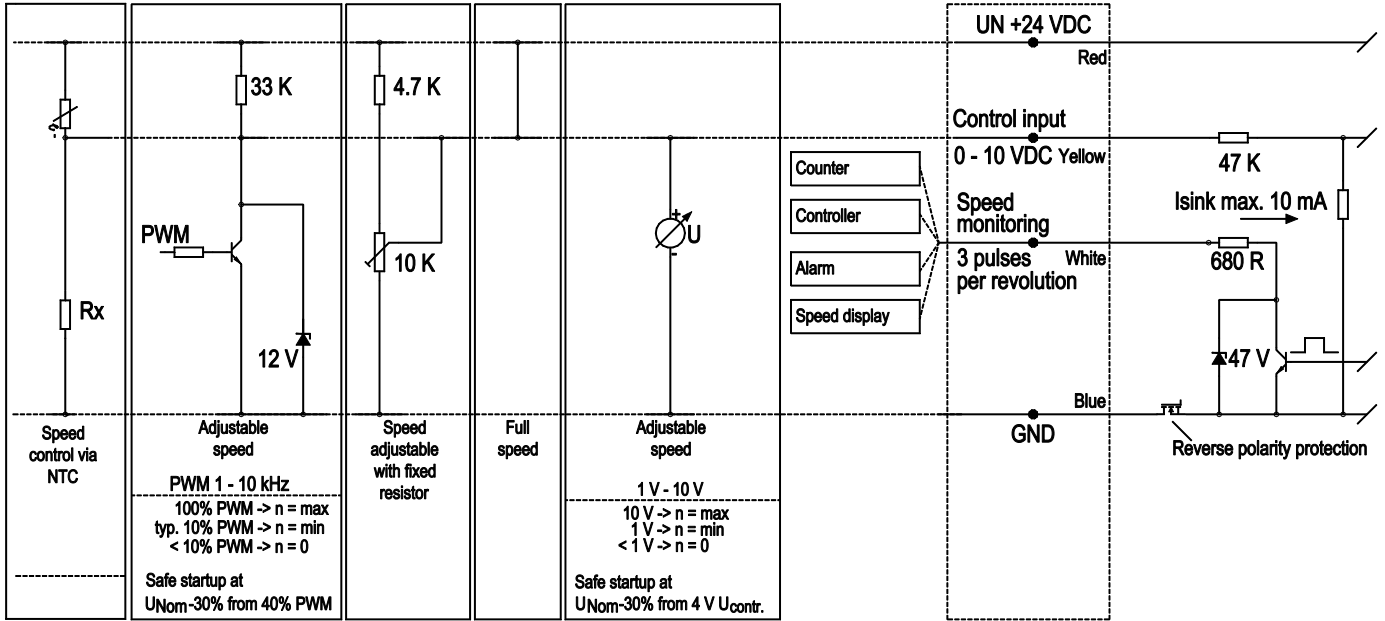

Curves: Air performance

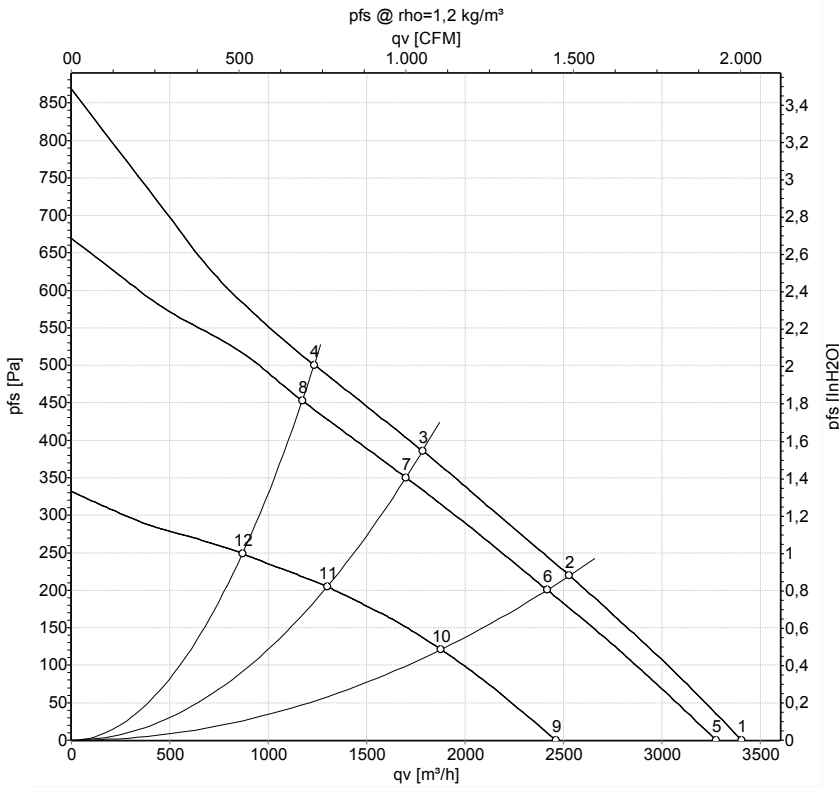

Measurement: LU-58923-1
 Measurement: LU-58922-1
 Measurement: LU-58924-1

Air performance measured according to ISO 5801 installation category A. For detailed information on the measurement setup, contact ebmpapst. Intake sound level: Sound power level according to ISO 13347 / sound pressure level measured at 1 m distance from fan axis. The values given are valid under the specified measuring conditions and may vary due to conditions of installation. For deviations from the standard configuration, the parameters have to be checked on the installed unit.

Measured values

	U	n	P _{ed}	I	q _v	p _{fs}	q _v	p _{fs}
	V	min ⁻¹	W	A	m ³ /h	Pa	cfm	inH ₂ O
1	28	1505	351	13.00	3405	0	2005	0.00
2	28	1405	352	13.00	2530	220	1490	0.88
3	28	1435	351	13.00	1785	386	1050	1.55
4	28	1520	353	13.00	1230	501	725	2.01
5	24	1450	300	13.00	3275	0	1930	0.00
6	24	1340	303	13.00	2415	200	1420	0.80
7	24	1365	302	13.00	1700	350	1000	1.41
8	24	1445	302	13.00	1170	450	690	1.81
9	16	1070	123	7.69	2460	0	1450	0.00
10	16	1045	138	8.69	1875	121	1105	0.49
11	16	1050	136	8.54	1300	205	765	0.82
12	16	1070	124	7.75	870	249	510	1.00

U = Power supply · n = Speed (rpm) · P_{ed} = Power consumption · I = Current draw · q_v = Air flow · p_{fs} = Pressure increase

