

R3G355-RB03-10 ebmpapst Datasheet FansCo  
 sales@fansco.com  
 www.fansco.com

### Nominal data

Type	R3G355-RB03-10	
Motor	M3G074-DF	
Phase		1~
Nominal voltage	VAC	230
Nominal voltage range	VAC	200 .. 240
Frequency	Hz	50/60
Method of obtaining data		ml
Speed (rpm)	min <sup>-1</sup>	1350
Power consumption	W	205
Current draw	A	2.0
Min. ambient temperature	°C	-25
Max. ambient temperature	°C	50

ml = Max. load · me = Max. efficiency · fa = Free air · cs = Customer specification · ce = Customer equipment  
 Subject to change

### Data according to Commission Regulation (EU) 327/2011

		Actual	Req. 2015
01 Overall efficiency $\eta_{es}$	%	64.7	44.2
02 Measurement category		A	
03 Efficiency category		Static	
04 Efficiency grade N		82.5	62
05 Variable speed drive		Yes	

Data obtained at optimum efficiency level.

The ErP data is determined using a motor-impeller combination in a standardized measurement setup.

09 Power consumption $P_{ed}$	kW	0.2
09 Air flow $q_v$	m <sup>3</sup> /h	2105
09 Pressure increase $p_{fs}$	Pa	196
10 Speed (rpm) $n$	min <sup>-1</sup>	1350
11 Specific ratio*		1.00

\* Specific ratio =  $1 + p_{fs} / 100\,000\text{ Pa}$

LU-187642



## Technical description

Weight	3.7 kg
Fan size	355 mm
Rotor surface	Thick-film passivated
Impeller material	PP plastic
Number of blades	6
Direction of rotation	Clockwise, viewed toward rotor
Degree of protection	IP54; installation- and position-dependent
Insulation class	"B"
Moisture (F) / Environmental (H) protection class	F3-1
Max. permitted ambient temp. for motor (transport/storage)	+ 80 °C
Min. permitted ambient temp. for motor (transport/storage)	- 40 °C
Installation position	Any
Condensation drainage holes	None, open rotor
Cooling hole/opening	On rotor side
Mode	S1
Motor bearing	Ball bearing
Technical features	<ul style="list-style-type: none"> <li>- Power limiter</li> <li>- Soft start</li> <li>- Thermal overload protection for motor</li> <li>- Line undervoltage detection</li> </ul>
Touch current according to IEC 60990 (measuring circuit Fig. 4, TN system)	<= 3.5 mA
Electrical hookup	With plug
Motor protection	Electronic motor protection
With cable	Variable
Protection class	I (with customer connection of protective earth)
Conformity with standards	EN 60335-1; CE
Approval	UL 1004-7 + 60730; C22.2 No.77 + CAN/CSA-E60730-1

Product drawing

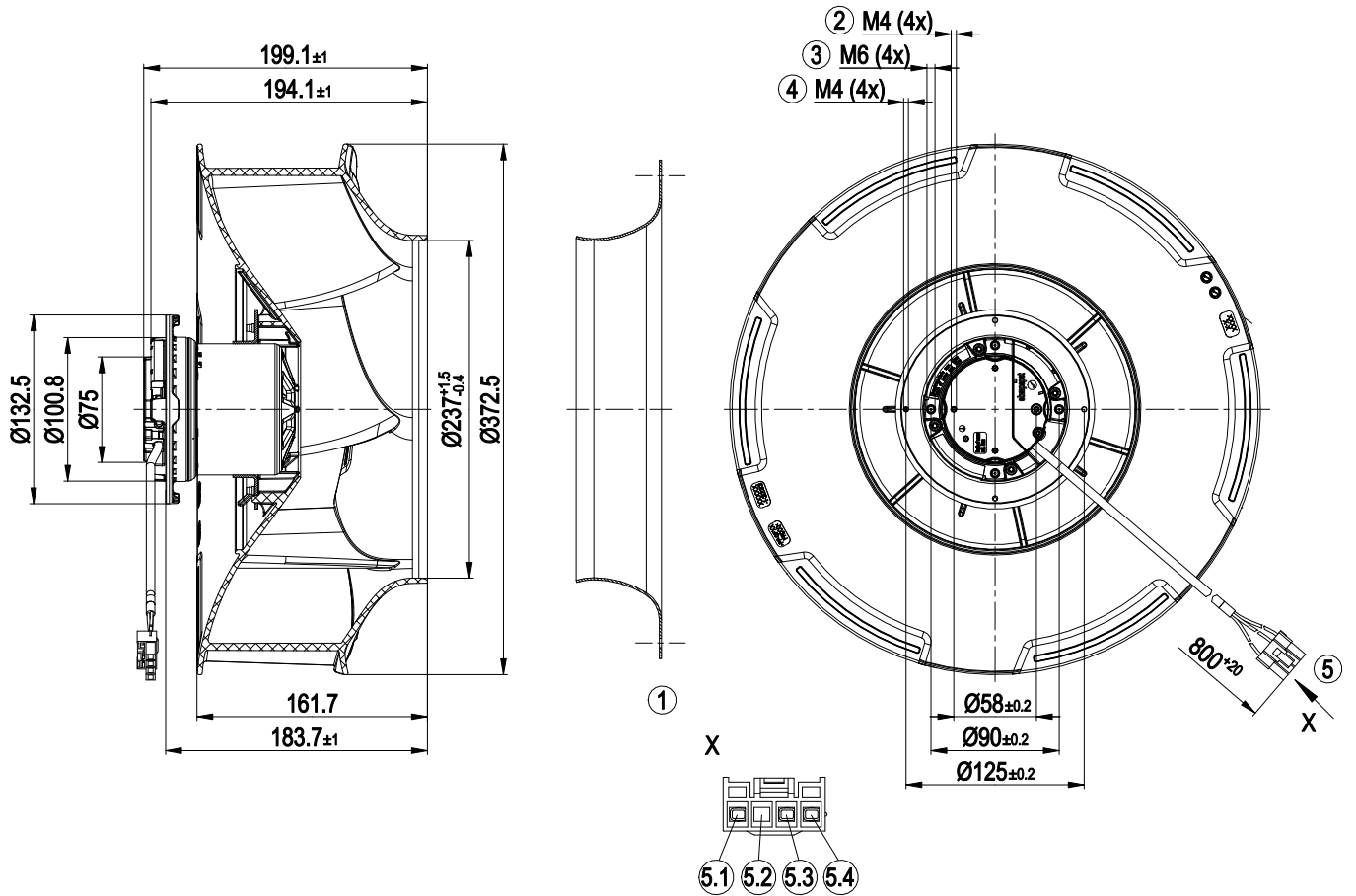

1	Accessory part: inlet ring 35560-2-4013 not included in scope of delivery
2	Max. clearance for screw 5 mm
3	Max. clearance for screw 10 mm
4	Max. clearance for screw 10 mm
5	Cable PVC AWG20, 4-pole connector housing JST VLP-04VN-1, 3x socket JST SVF-61T-P2.0 crimped
5.1	PE (green/yellow)
5.2	not used
5.3	N (black)
5.4	L (blue)

Accessory part

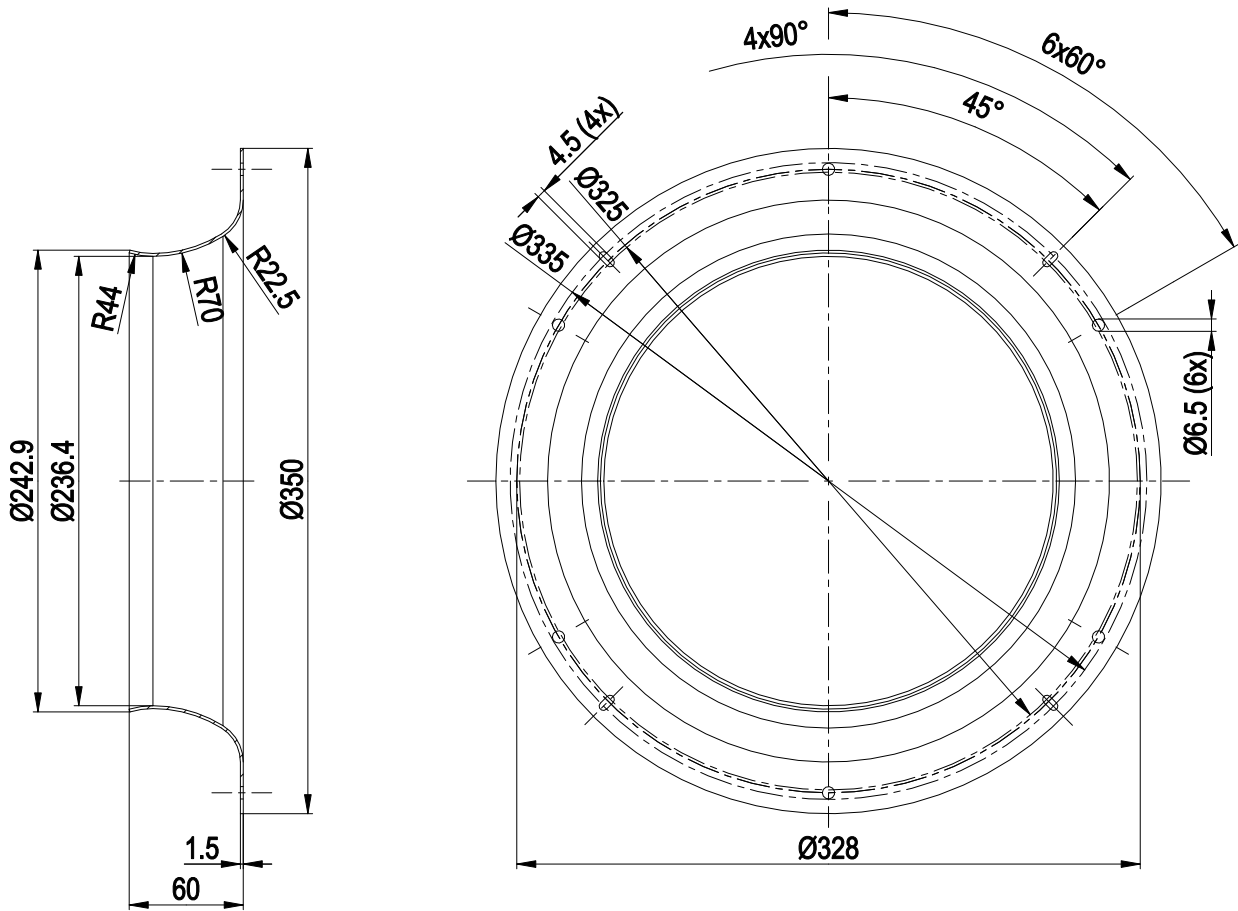

Inlet ring 35560-2-4013

## Connection diagram

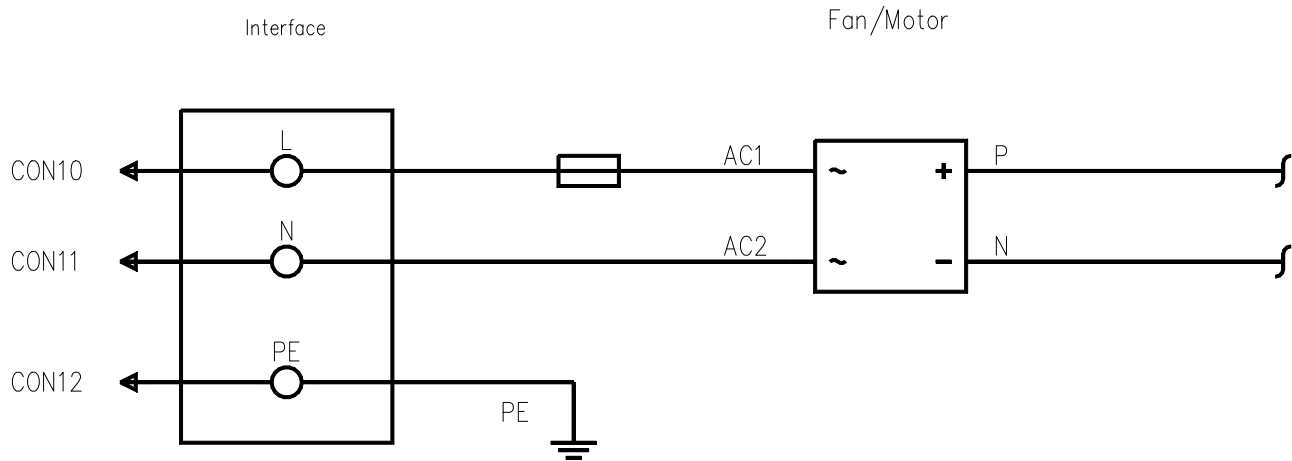

No.	Conn.	Designation	Color	Function/assignment
	L	CON10	black	Power supply, phase, see nameplate for voltage range
	N	CON11	blue	Power supply, neutral conductor, see nameplate for voltage range
	PE	CON12	green/yellow	Protective earth

## Curves: Air performance 50 Hz

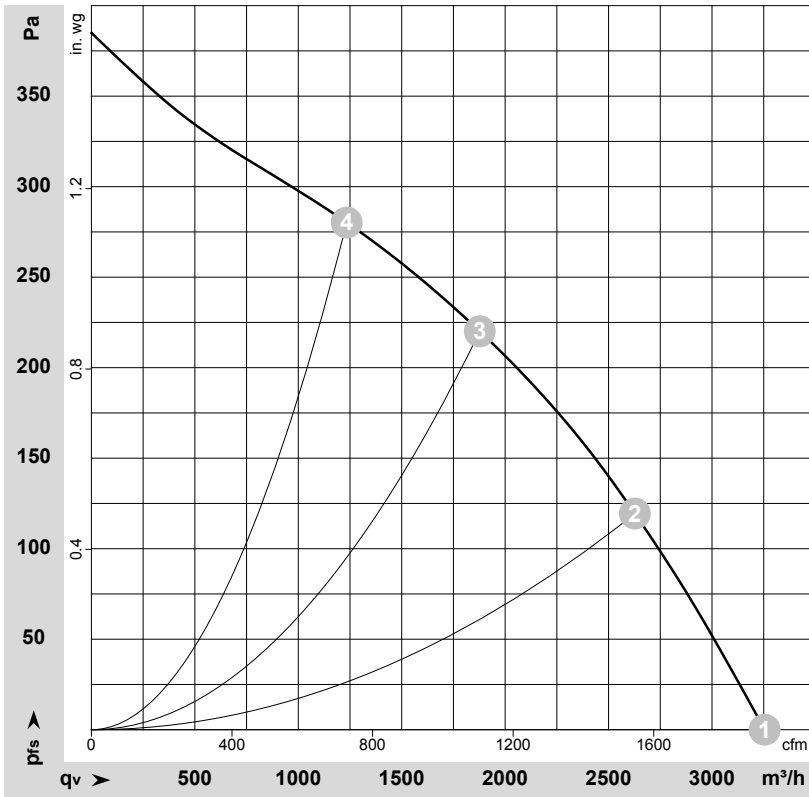

$\rho = 1.15 \text{ kg/m}^3 \pm 2 \%$

Measurement: LU-187642-1

Air performance measured according to ISO 5801 installation category A. For detailed information on the measurement setup, contact ebmpapst. Intake sound level: Sound power level according to ISO 13347 / sound pressure level measured at 1 m distance from fan axis. The values given are valid under the specified measuring conditions and may vary due to conditions of installation. For deviations from the standard configuration, the parameters have to be checked on the installed unit.

## Measured values

	Wired	U	f	n	P <sub>ed</sub>	I	q <sub>v</sub>	p <sub>fs</sub>	q <sub>v</sub>	p <sub>fs</sub>
		V	Hz	min <sup>-1</sup>	W	A	m <sup>3</sup> /h	Pa	cfm	in. wg
1	1~	230	50	1425	158	1.53	3255	0	1915	0.00
2	1~	230	50	1370	190	1.82	2625	120	1545	0.48
3	1~	230	50	1350	205	2.00	1875	220	1105	0.88
4	1~	230	50	1365	192	1.84	1235	280	725	1.12

Wired = Wiring · U = Power supply · f = Frequency · n = Speed (rpm) · P<sub>ed</sub> = Power consumption · I = Current draw · q<sub>v</sub> = Air flow · p<sub>fs</sub> = Pressure increase

