

# EC centrifugal fan - RadiCal

backward-curved, single-intake

for rail applications

R3G310-RU29-82 ebmpapst Datasheet FansCo

sales@fansco.com

www.fansco.com

## Nominal data

Type	R3G310-RU29-82	
Motor	M3G084-CF	
Nominal voltage	V	24
Nominal voltage range	V	16 .. 32
Method of obtaining data		fa
Status		prelim.
Speed (rpm)	min <sup>-1</sup>	2550
Power consumption	W	470
Current draw	A	19.5
Min. ambient temperature	°C	-40
Max. ambient temperature	°C	60

ml = Max. load · me = Max. efficiency · fa = Free air · cs = Customer specification · ce = Customer equipment  
Subject to change



### Technical description

Weight	3.62 kg
Size	310 mm
Motor size	84
Rotor surface	Painted black
Electronics housing material	Die-cast aluminum, painted black
Impeller material	PA plastic
Number of blades	6
Direction of rotation	Clockwise, viewed toward rotor
Degree of protection	Motor IP24 KM, electronics IP6K9K (mating connector installed)
Insulation class	"B"
Moisture (F) / Environmental (H) protection class	H3
Max. permitted ambient temp. for motor (transport/storage)	+80 °C
Min. permitted ambient temp. for motor (transport/storage)	-40 °C
Installation position	Shaft horizontal or rotor on bottom; rotor on top on request
Cooling hole/opening	On rotor side
Mode	S1
Motor bearing	Ball bearing
Technical features	<ul style="list-style-type: none"> <li>- Start at 85 °C (2 min) permitted</li> <li>- Error output (high-side switch)</li> <li>- Run monitoring</li> <li>- Load dump (58 V)</li> <li>- Motor current limitation</li> <li>- Soft start</li> <li>- Control input 10-0 VDC / PWM</li> <li>- Standstill on cable break</li> <li>- Temperature derating</li> <li>- Overvoltage detection</li> <li>- Thermal overload protection for electronics</li> <li>- Line undervoltage detection</li> <li>- Reverse polarity protection</li> </ul>
Electrical hookup	Standby current less than 500 µA
With cable	Lateral
Protection class	III
Conformity with standards	EN 15085-1+A1:2013, CPC3; EN 45545-2:2020, HL3; EN 50155:2017; EN 61373:2010, Cat.1B; CE
Approval	EAC

# EC centrifugal fan - RadiCal

backward-curved, single-intake  
for rail applications

## Product drawing

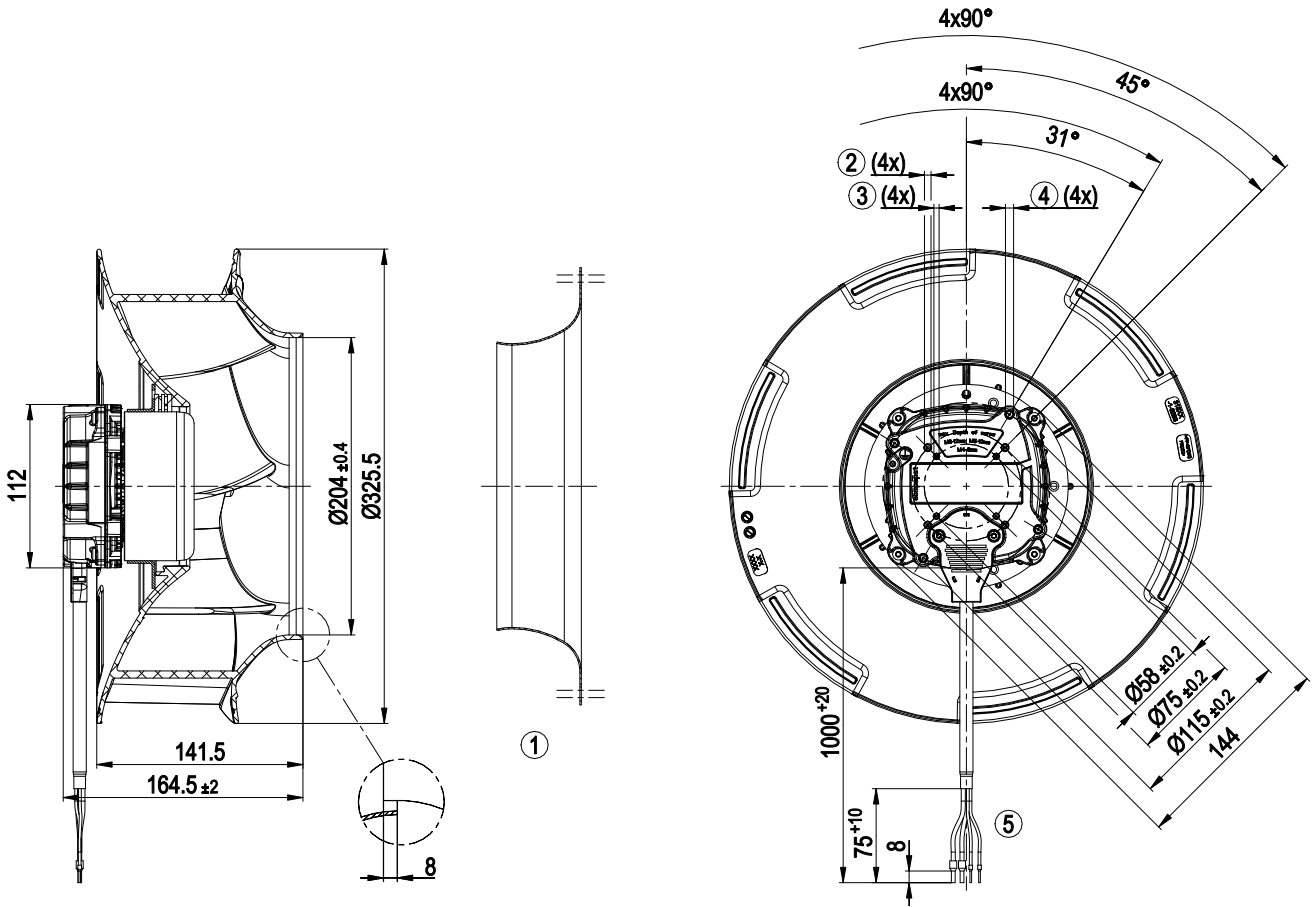

1	Accessory part: inlet ring 31000-2-4013 not included in scope of delivery
2	Tapping hole prepared for self-tapping M5 screw, max. screw-in depth 10 mm
3	Tapping hole prepared for self-tapping M4 screw, max. screw-in depth 8 mm
4	Tapping hole prepared for self-tapping M6 screw, max. screw-in depth 12 mm
5	Cable, halogen-free, railway application EN 45545, 2x 6.0 mm <sup>2</sup> , 2x 1.0 mm <sup>2</sup>
	4x wire-end ferrule



# EC centrifugal fan - RadiCal

backward-curved, single-intake  
for rail applications

## Accessory part

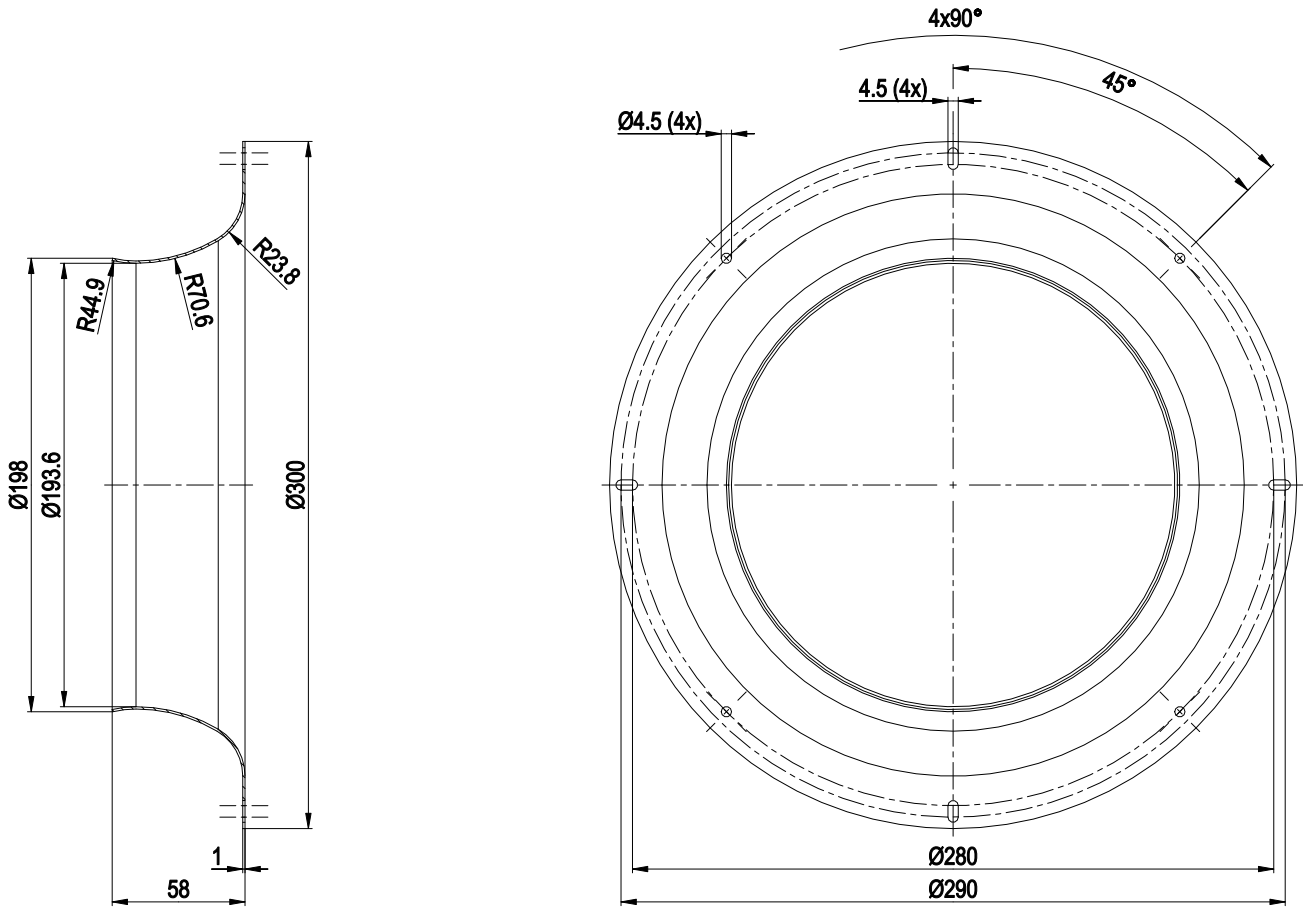

Inlet ring 31000-2-4013



# EC centrifugal fan - RadiCal

backward-curved, single-intake

for rail applications

## Connection diagram

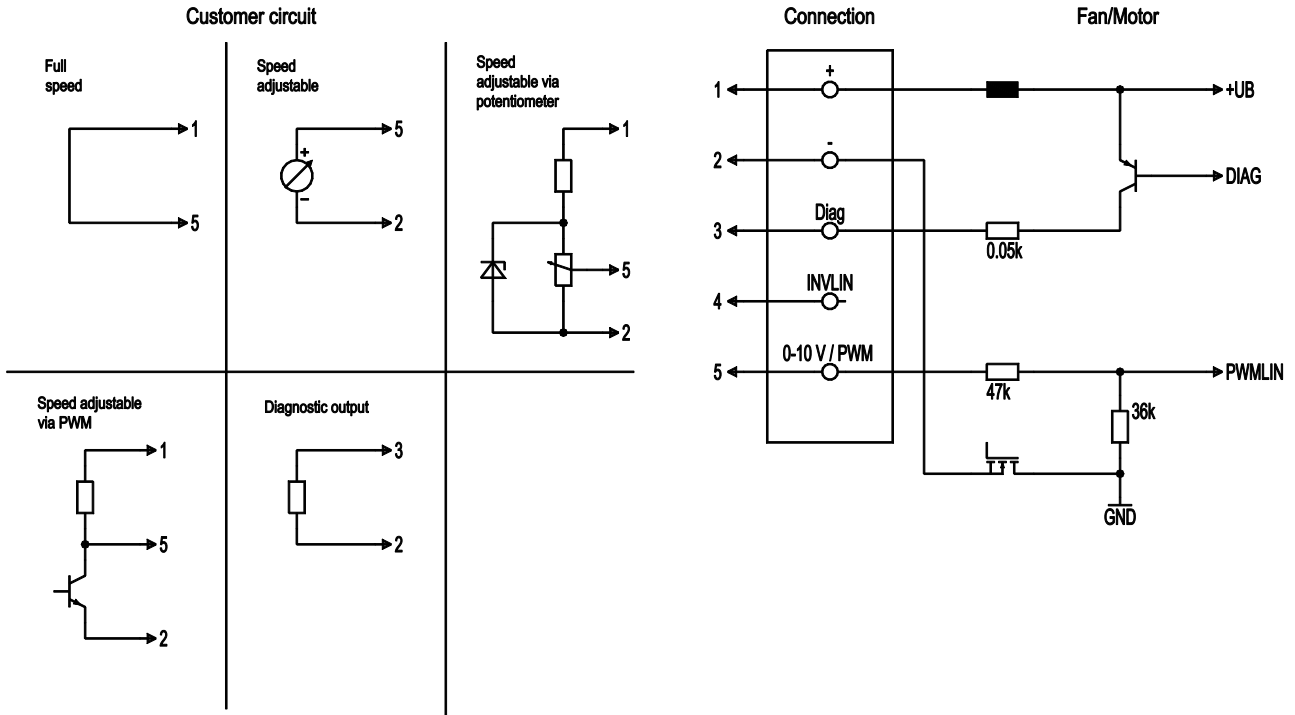

No.	Conn.	Designation	Color	Function/assignment
	1	+	black	Power supply, see nameplate for voltage range
	2	-	brown	Power supply, see nameplate for voltage range
	3	DIAG	white	Diagnostic output: Open collector, I <sub>source</sub> max = 20 mA, Fan OK -> high; fan error -> low
	4	INVLIN		not used
	5	0-10 V / PWM	yellow	Control input: R <sub>i</sub> > 47 kΩ 0-10 V (typ. < 1 V -> n=0; 1.5 V -> n=min; > 10 V -> n=max) PWM (amplitude 10 V; 1-50 kHz; typ. < 5 % -> n=0; 15% -> n=min; > 100% -> n=max)



## Curves: Air performance

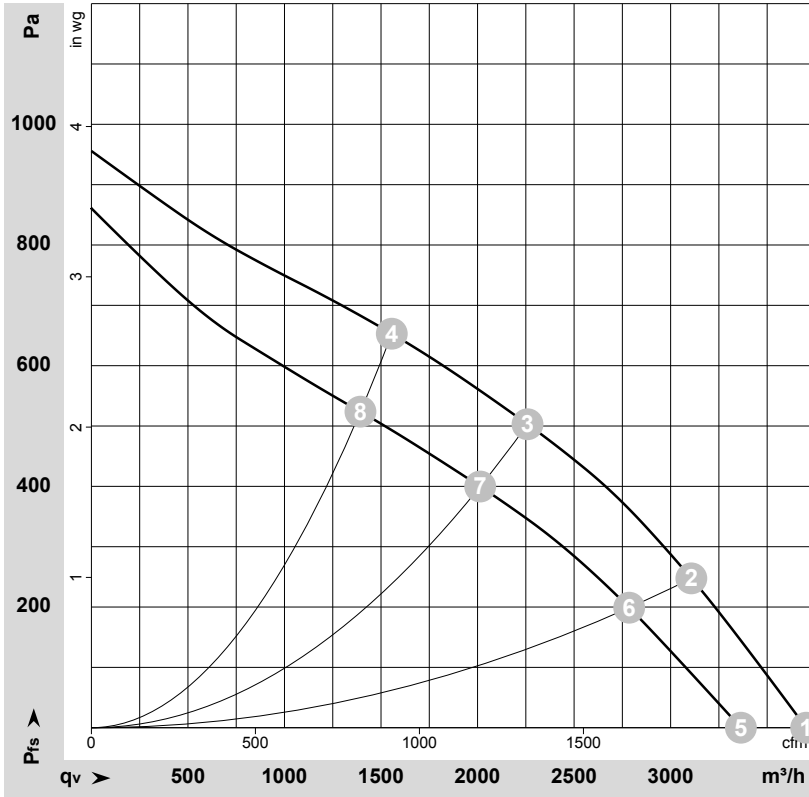

$\rho = 1.15 \text{ kg/m}^3 \pm 2 \%$

Measurement: LU-181040-1  
Measurement: LU-181070-1

Air performance measured according to ISO 5801 installation category A. For detailed information on the measurement setup, contact ebmpapst. Intake sound level: Sound power level according to ISO 13347 / sound pressure level measured at 1 m distance from fan axis. The values given are valid under the specified measuring conditions and may vary due to conditions of installation. For deviations from the standard configuration, the parameters have to be checked on the installed unit.

## Measured values

	U	n	P <sub>ed</sub>	I	LpA <sub>in</sub>	LwA <sub>in</sub>	q <sub>v</sub>	P <sub>fs</sub>	q <sub>v</sub>	P <sub>fs</sub>
	V	min <sup>-1</sup>	W	A	dB(A)	dB(A)	m <sup>3</sup> /h	Pa	cfm	in. wg
1	24-32	2550	470	19.50*	74	81	3700	0	2180	0.00
2	24-32	2430	538	22.40*	71	78	3105	250	1830	1.00
3	24-32	2380	581	24.20*	67	74	2260	500	1330	2.01
4	24-32	2400	556	23.10*	69	76	1555	650	915	2.61
5	16	2305	372	23.27			3365	0	1980	0.00
6	16	2190	410	25.52			2785	199	1640	0.80
7	16	2125	432	26.89			2015	400	1185	1.61
8	16	2155	422	26.37			1395	524	820	2.10

U = Voltage · n = Speed (rpm) · P<sub>ed</sub> = Power consumption · I = Current draw · \* = Current measured at nominal voltage · LpA<sub>in</sub> = Sound pressure level intake side · LwA<sub>in</sub> = Sound power level intake side  
q<sub>v</sub> = Air flow · P<sub>fs</sub> = Pressure increase

