

R3G250-AV29-B1

EC centrifugal fan - RadiPac

backward-curved, single-intake



R3G250-AV29-B1 ebmpapst Datasheet

sales@fansco.com

www.fansco.com

Nominal data

Type	R3G250-AV29-B1	
Motor	M3G084-FA	
Phase		1~
Nominal voltage	VAC	230
Nominal voltage range	VAC	200 .. 277
Frequency	Hz	50/60
Method of obtaining data		ml
Speed (rpm)	min ⁻¹	3450
Power consumption	W	750
Current draw	A	3.3
Min. ambient temperature	°C	-25
Max. ambient temperature	°C	40

ml = Max. load · me = Max. efficiency · fa = Free air · cs = Customer specification · ce = Customer equipment
Subject to change

Data according to Commission Regulation (EU) 327/2011 (prEN 17166)

		Actual	Req. 2015			
01 Overall efficiency η_{es}	%	58.9	50	09 Power consumption P_{ed}	kW	0.72
02 Measurement category		A		09 Air flow q_v	m ³ /h	1975
03 Efficiency category		Static		09 Pressure increase p_{fs}	Pa	708
04 Efficiency grade N		70.9	62	10 Speed (rpm) n	min ⁻¹	3480
05 Variable speed drive		Yes		11 Specific ratio*		1.01

Data obtained at optimum efficiency level.

* Specific ratio = $1 + p_g / 100\,000\text{ Pa}$

LU-159090

The efficiency values displayed for achieving conformity with the Ecodesign Regulation EU 327/2011 has been reached with defined air duct components (e.g. inlet rings). The dimensions must be requested from ebm-papst. If other air conduction geometries are used on the installation side, the ebm-papst evaluation loses its validity/the conformity must be confirmed again. The product does not fall within the scope of Regulation (EU) 2019/1781 due to the exception specified in Article 2 (2a) (motors completely integrated into a product).

Technical description

Weight	5.6 kg
Size	250 mm
Motor size	84
Rotor surface	Painted black
Electronics housing material	Die-cast aluminum
Impeller material	Sheet aluminum
Number of blades	7
Direction of rotation	Clockwise, viewed toward rotor
Degree of protection	IP54
Insulation class	"B"
Moisture (F) / Environmental (H) protection class	H1
Max. permitted ambient temp. for motor (transport/storage)	+80 °C
Min. permitted ambient temp. for motor (transport/storage)	-40 °C
Installation position	Shaft horizontal or rotor on bottom; rotor on top on request
Condensation drainage holes	On rotor side
Mode	S1
Motor bearing	Ball bearing
Technical features	<ul style="list-style-type: none"> - Output 10 VDC, max. 10 mA - Output 20 VDC, max. 50 mA - Output for slave 0-10 V - Input for sensor 0-10 V or 4-20 mA - Alarm relay - Power limiter - Motor current limitation - PFC, active - RS-485 MODBUS-RTU - Soft start - Control input 0-10 VDC / PWM - Control interface with SELV potential safely disconnected from the mains - Thermal overload protection for electronics/motor - Line undervoltage / phase failure detection
EMC immunity to interference	According to EN 61000-6-2 (industrial environment)
EMC circuit feedback	According to EN 61000-3-2/3
EMC interference emission	According to EN 61000-6-4 (industrial environment)
Touch current according to IEC 60990 (measuring circuit Fig. 4, TN system)	<= 3.5 mA
Electrical hookup	Terminal box
Motor protection	Thermal switch auto reset, internally connected
Protection class	I (with customer connection of protective earth)
Conformity with standards	EN 61800-5-1; CE
Approval	EAC

Product drawing

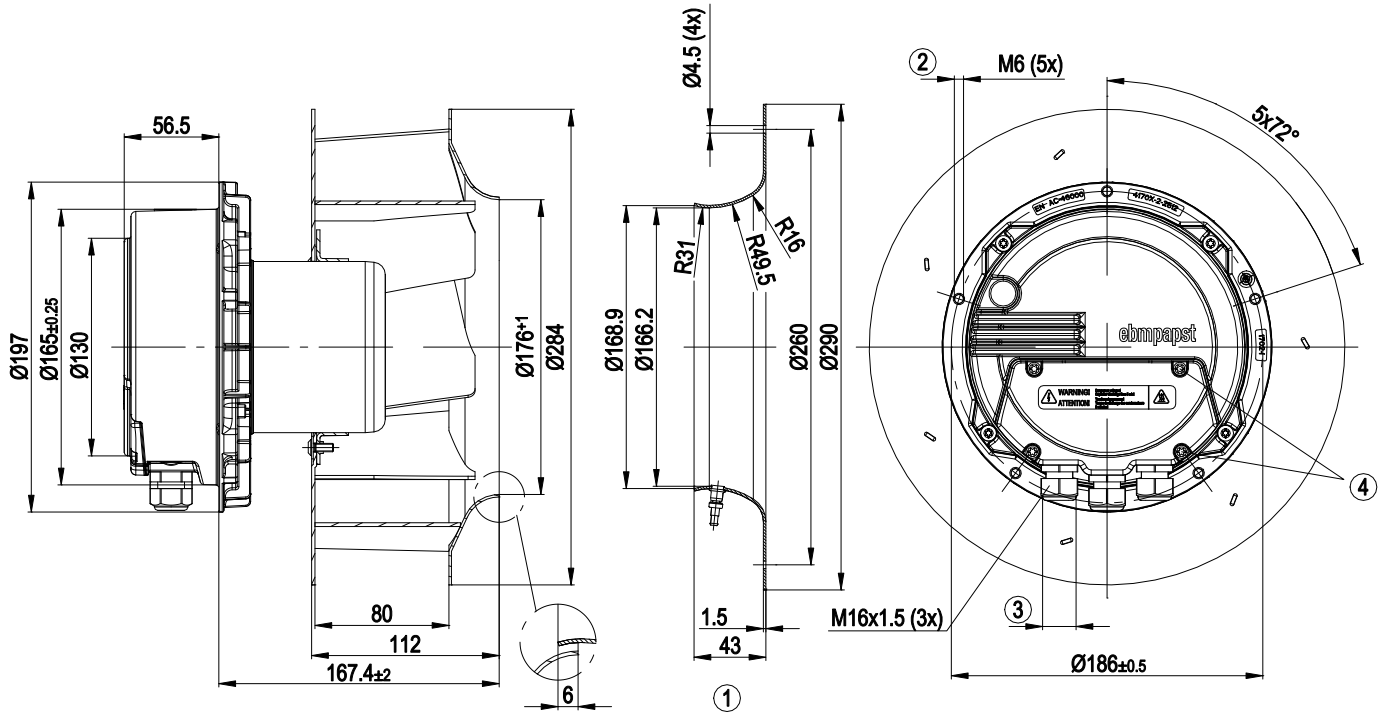

1	Accessory part: Inlet ring 25075-2-4013 with pressure tap (k-factor:70) not included in scope of delivery.
2	Cable diameter min. 4 mm, max. 10 mm; tightening torque 2.5±0.4 Nm
3	Max. clearance for screw 16 mm
4	Tightening torque 3.5 ± 0.5 Nm

Curves: Air performance 50 Hz

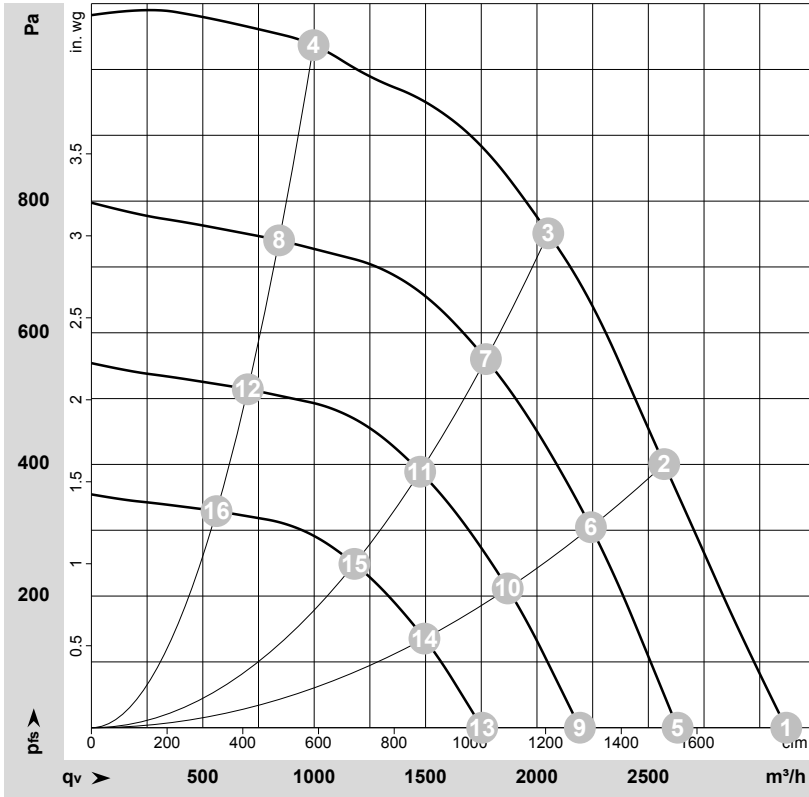

$\rho = 1.15 \text{ kg/m}^3 \pm 2 \%$

Measurement: LU-142908-1
Date: 2012-05-15
Nozzle: 25070-2-4013

Air performance measured according to ISO 5801 installation category A. For detailed information on the measurement setup, contact ebmpapst. Intake sound level: Sound power level according to ISO 13347 / sound pressure level measured at 1 m distance from fan axis. The values given are valid under the specified measuring conditions and may vary due to conditions of installation. For deviations from the standard configuration, the parameters have to be checked on the installed unit.

Measured values

	Wired	U	f	n	P _{ed}	I	LpA _{in}	LwA _{in}	LwA _{out}	q _v	p _{fs}	q _v	p _{fs}
		V	Hz	min ⁻¹	W	A	dB(A)	dB(A)	dB(A)	m ³ /h	Pa	cfm	in. wg
1	1~	230	50	3450	581	2.58	77	85	91	3120	0	1835	0.00
2	1~	230	50	3450	678	3.00	74	82	88	2570	400	1515	1.61
3	1~	230	50	3450	750	3.30	71	79	84	2050	750	1205	3.01
4	1~	230	50	3450	652	2.89	78	86	88	995	1050	585	4.22
5	1~	230	50	3000	349	1.55	73	80	87	2630	0	1550	0.00
6	1~	230	50	3000	450	1.99	70	78	84	2240	305	1320	1.22
7	1~	230	50	3000	490	2.18	67	75	81	1770	561	1040	2.25
8	1~	230	50	3000	392	1.74	74	82	84	845	741	495	2.97
9	1~	230	50	2500	202	0.90	68	76	82	2195	0	1290	0.00
10	1~	230	50	2500	260	1.15	66	74	79	1870	212	1100	0.85
11	1~	230	50	2500	284	1.26	63	70	76	1475	390	870	1.57
12	1~	230	50	2500	227	1.01	70	77	79	700	515	415	2.07
13	1~	230	50	2000	103	0.46	63	70	76	1755	0	1030	0.00
14	1~	230	50	2000	133	0.59	60	68	74	1495	136	880	0.55
15	1~	230	50	2000	145	0.64	57	65	71	1180	249	695	1.00
16	1~	230	50	2000	116	0.52	64	71	74	560	329	330	1.32

Wired = Wiring · U = Voltage · f = Frequency · n = Speed (rpm) · P_{ed} = Power consumption · I = Current draw · LpA_{in} = Sound pressure level intake side · LwA_{in} = Sound power level intake side · LwA_{out} = Sound power level outlet side · q_v = Air flow · p_{fs} = Pressure increase