

M6E068-EC10-11 ebmpapst Datasheet  
 sales@fansco.com  
 www.fansco.com

Limited partnership · Headquarters Muldingen  
 County court Stuttgart · HRA 590344

General partner Elektrobau Muldingen GmbH · Headquarters Muldingen  
 County court Stuttgart · HRB 590142

## Nominal data

Type	M6E068-EC10-11		
Motor	M6E068-EC		
Phase		1~	1~
Nominal voltage	VAC	230	230
Frequency	Hz	50	60
Type of data definition		me	me
Valid for approval / standard		CE	CE
Speed	min <sup>-1</sup>	850	1050
Power input	W	152	148
Power output	W	72	75
Current draw	A	0.69	0.65
Rated torque	Ncm	81	75
Medium start-up torque	Ncm	40	45
Motor capacitor	µF	4	4
Capacitor voltage	VDB	400	450
Capacitor standard		P0 (CE)	
Min. ambient temperature	°C	-25	-25
Max. ambient temperature	°C	-	-
Starting current	A	1.05	0.97

ml = max. load · me = max. efficiency · fa = running at free air · cs = customer specs · cu = customer unit  
 Subject to alterations



### Technical features

<b>Mass</b>	2.5 kg
<b>Size</b>	68 mm
<b>Surface of rotor</b>	Coated in black
<b>Direction of rotation</b>	Counter-clockwise, seen on rotor
<b>Type of protection</b>	IP 44; Depending on installation and position
<b>Insulation class</b>	"B"
<b>Humidity class</b>	F1-2
<b>Max. permissible ambient motor temp. (transp./ storage)</b>	+ 80 °C
<b>Min. permissible ambient motor temp. (transp./storage)</b>	- 40 °C
<b>Mounting position</b>	Shaft horizontal or rotor on bottom; rotor on top on request
<b>Condensate discharge holes</b>	Rotor-side
<b>Operation mode</b>	S1
<b>Motor bearing</b>	Ball bearing
<b>Touch current acc. IEC 60990 (measuring network Fig. 4, TN system)</b>	< 0.75 mA
<b>Motor protection</b>	Thermal overload protector (TOP) brought out
<b>Cable exit</b>	Lateral
<b>Protection class</b>	I (if protective earth is connected by customer)
<b>Product conforming to standard</b>	EN 60335-1; CE

Product drawing

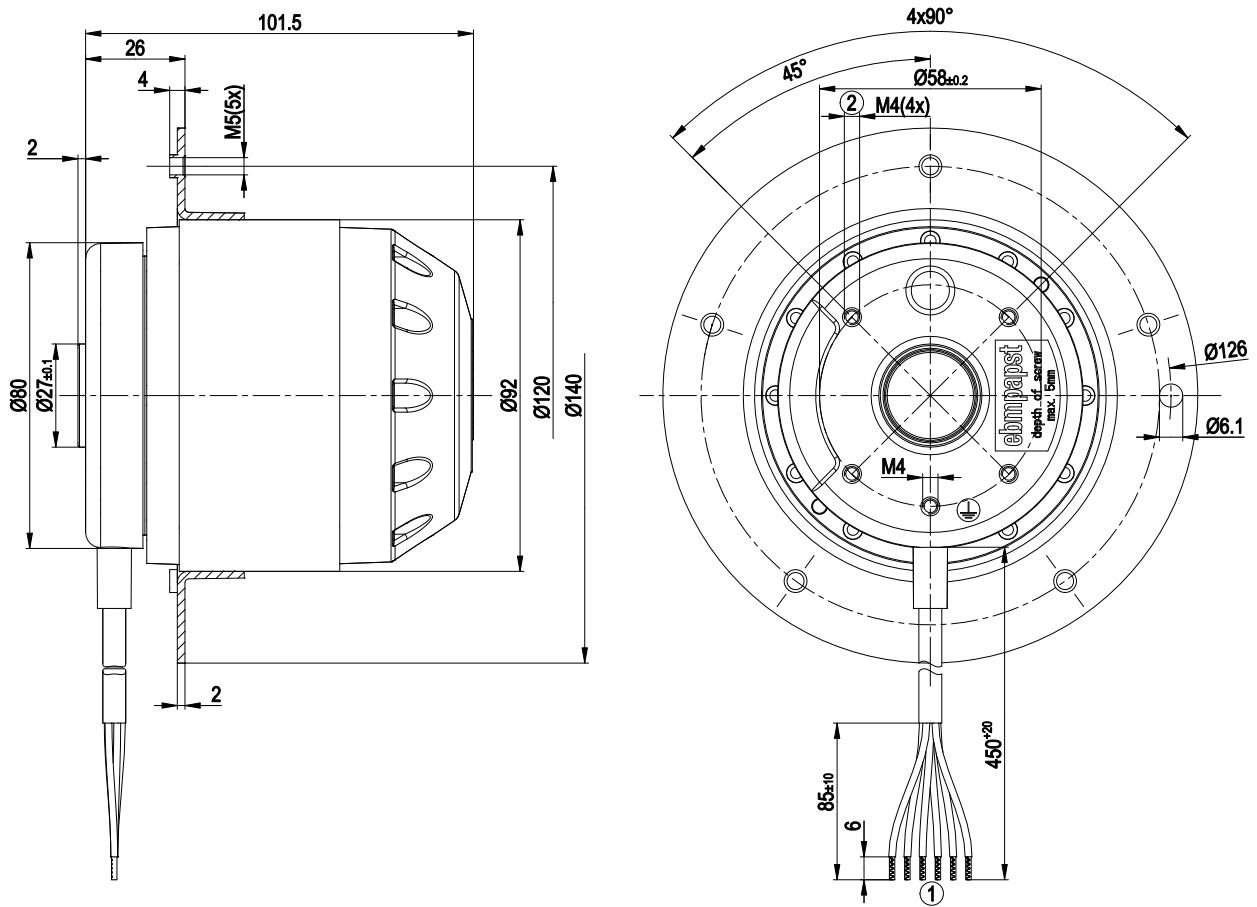

- 1 Connection line PVC 6G 0.5 mm<sup>2</sup>, 6 x brass lead tips crimped
- 2 Depth of screw max. 5 mm



## Connection screen

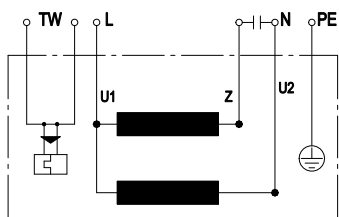

U1	Blue	Z	brown	U2	black
PE	green/yellow	TOP	2 x grey		



## Charts: Speed

