

M3G084-DF43-28 ebmpapst Datasheet
 sales@fansco.com
 www.fansco.com

Limited partnership · Headquarters Muldingen
 County court Stuttgart · HRA 590344

General partner Elektrobau Muldingen GmbH · Headquarters Muldingen
 County court Stuttgart · HRB 590142

Nominal data

Type	M3G084-DF43-28	
Motor	M3G084-DF	
Nominal voltage	VDC	370
Nominal voltage range	VDC	344 .. 383
Type of data definition		ml/cu
State		prelim.
Speed (rpm)	min ⁻¹	3140
Power input	W	465
Power output	W	395
Current draw	A	1.26
Min. ambient temperature	°C	-25
Max. ambient temperature	°C	50

ml = Max. load · me = Max. efficiency · fa = Running at free air · cs = Customer specs · cu = Customer unit
 Subject to alterations



Technical features

Mass	2.9 kg
Motor size	84
Surface of rotor	Coated in black
Material of protective cover	PA plastic
Direction of rotation	Clockwise, seen on rotor
Protection rating	IP54
Insulation class	"F"
Humidity (F) / environmental protection class (H)	H0 - dry environment
Max. permissible ambient motor temp. (transp./ storage)	+80 °C
Min. permissible ambient motor temp. (transp./storage)	-40 °C
Mounting position	Any
Condensation drainage holes	None
Operation mode	S1
Motor bearing	Ball bearing
Electrical connection	Plug
Cable exit	Lateral
Protection class	I (if protective earth is connected by customer)
Product conforming to standard	EN 61800-5-1
Approval	UL 1004-1; CSA C22.2 no. 100



Product drawing

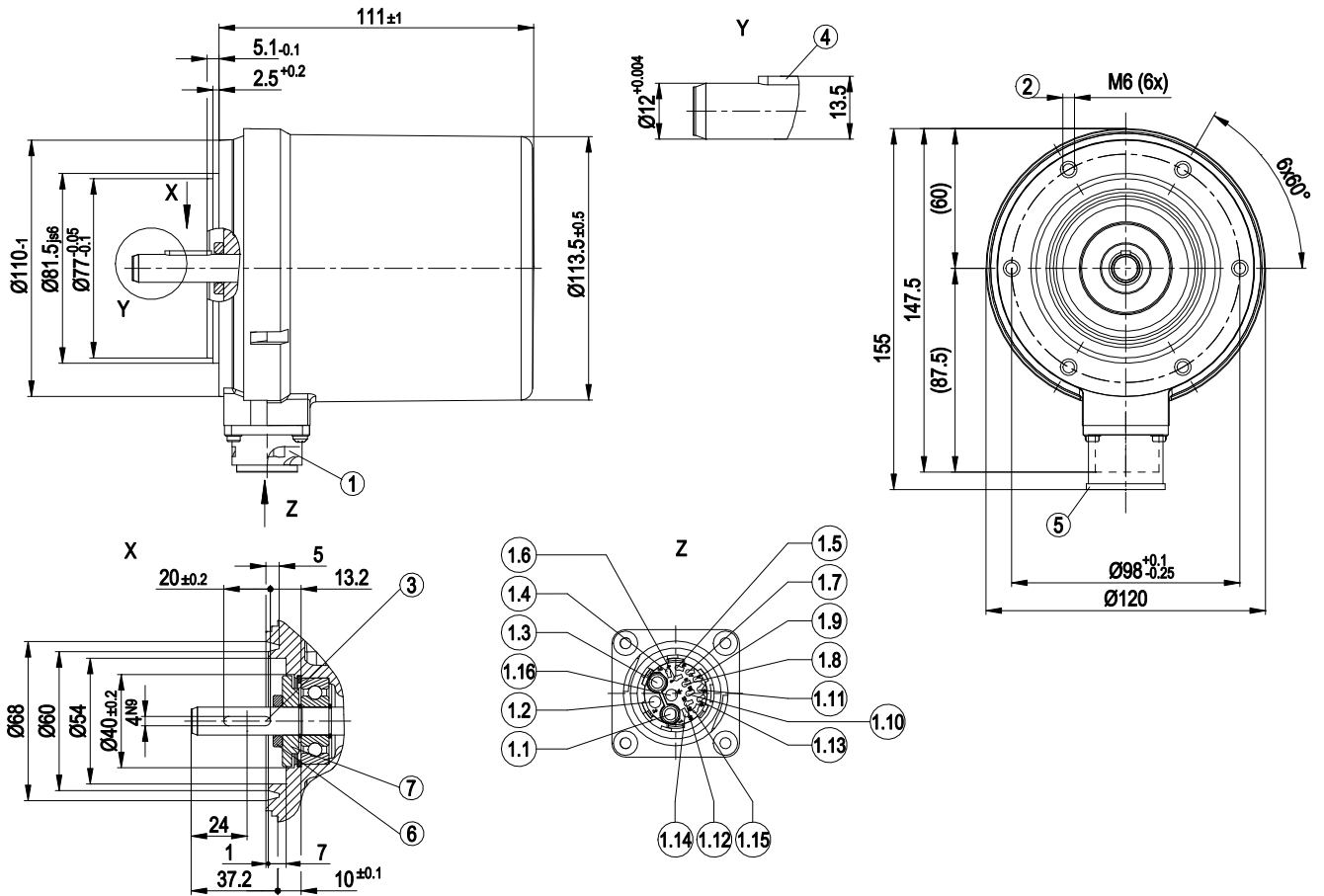

1	Connector housing Amphenol no. C016 10C015 000 5 with number of poles 12 + 3 + PE, 4x plug pin HN01 016 0002(1), 6x plug pin HN01-015-0046-2
1.1	V/Z motor line
1.2	W/X motor line
1.3	U/Y motor line
1.4	not used
1.5	Position indicator 2 (Hall 20)
1.6	not used
1.7	Position indicator 3 (Hall 30)
1.8	not used
1.9	Position indicator 1 (Hall 10)
1.10	not used
1.11	Position indicator 4 (tacho)
1.12	not used
1.13	+ (10 - 24 V)
1.14	not used
1.15	- (earth)
1.16	PE
2	Thread reach max. 12 mm
3	Groove depth 2.5 mm +0.05
4	Key (Sumitomo 200761 supplied)



5	Protective cap Art.: N080300006
6	Oil seal (Sumitomo AU0344 G supplied)
7	Adjustment ring (Sumitomo AU3118 G supplied)

Connection screen

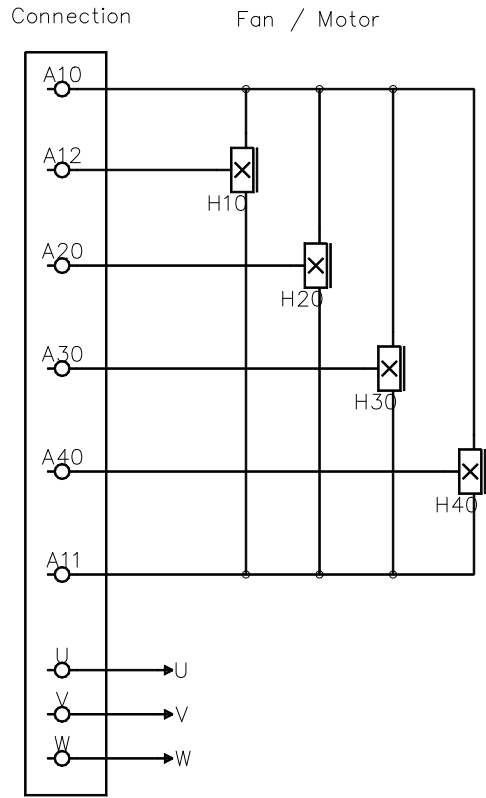

No.	Conn.	Designation	Function / assignment
	A10		Power supply 10-24 V
	A12	Lagegeber 1	Hall signal H10
	A20	Lagegeber 2	Hall signal H20
	A30	Lagegeber 3	Hall signal H30
	A40	Lagegeber 4	Gear sensor H40
	A11		GND
	U		Coil connection U
	V		Coil connection V
	W		Coil connection W



Charts: Speed (rpm)

