

M1G055-BD87-20 ebmpapst Datasheet
 sales@fansco.com
 www.fansco.com

Nominal data

Type	M1G055-BD87-20		
Motor	M1G055-BD		
Phase		1~	1~
Nominal voltage	VAC	230	230
Frequency	Hz	50/60	50/60
Method of obtaining data		ml	ml
Speed (rpm)	min ⁻¹	1400	1000
Power consumption	W	8.7	
Power output	W	5.8	-
Current draw	A	0.07	
Rated torque	Ncm	3.9	3.9
Min. ambient temperature	°C	-30	-30
Max. ambient temperature	°C	50	50

ml = Max. load · me = Max. efficiency · fa = Free air · cs = Customer specification · ce = Customer equipment
 Subject to change



Technical description

Weight	0.82 kg
Motor size	55
Rotor surface	Painted black
Electronics housing material	Die-cast aluminum
Direction of rotation	Counterclockwise, viewed toward rotor
Degree of protection	IP54; only with suitable plug, to be installed by customer
Insulation class	"B"
Moisture (F) / Environmental (H) protection class	H1
Max. permitted ambient temp. for motor (transport/storage)	+ 80 °C
Min. permitted ambient temp. for motor (transport/storage)	- 40 °C
Installation position	Any
Condensation drainage holes	None
Mode	S1
Motor bearing	Ball bearing
Technical features	- Speed selection max./min. - Soft start - Thermal overload protection for motor
Speed levels	2
EMC immunity to interference	According to EN 61000-6-2
EMC circuit feedback	According to EN 61000-3-2/3
EMC interference emission	According to EN 61000-6-3 (household environment)
Electrical hookup	Plug
Motor protection	Thermal overload protector (TOP) internally connected
With cable	Lateral
Protection class	II
Conformity with standards	EN 60335-1; EN 60335-2-24; EN 60335-2-80; EN 60335-2-89; CE
Approval	VDE; CSA C22.2 No. 77; UL 1004-3

Product drawing

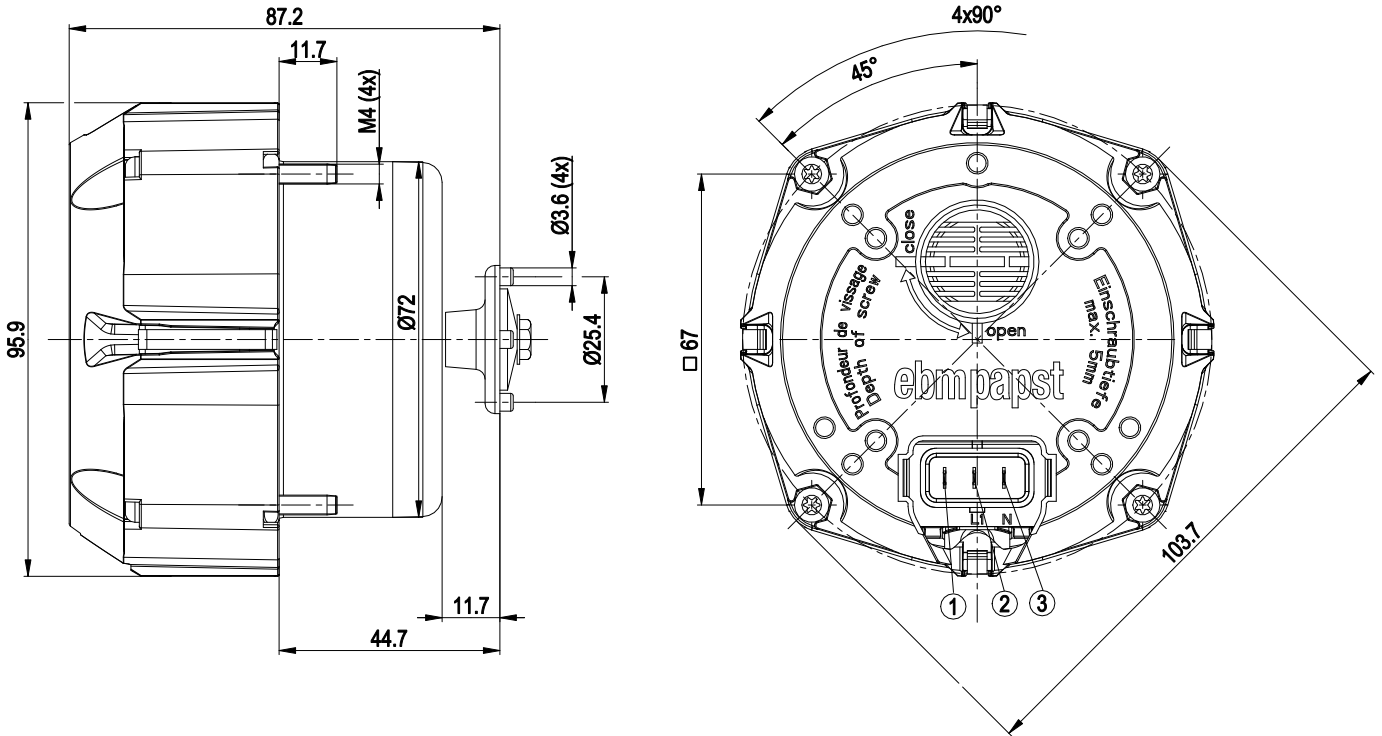

1	Pin S, speed selection (flat plug 2.8 x 0.5)
2	Pin L1, phase (flat plug 2.8 x 0.5)
3	Pin N, neutral conductor (flat plug 2.8 x 0.5)

Connection diagram

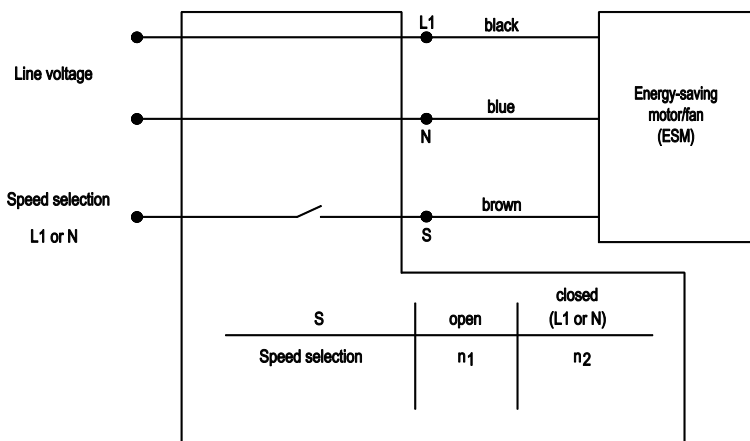

Curves: Speed (rpm)

