

# EC centrifugal module - RadiCal

backward curved, single inlet  
with support bracket

K3G500-RL96-07 ebmpapst Datasheet  
sales@fansco.com  
www.fansco.com

Limited partnership · Headquarters Muldingen  
County court Stuttgart · HRA 590344

General partner Elektrobau Muldingen GmbH · Headquarters Muldingen  
County court Stuttgart · HRB 590142

## Nominal data

Type	K3G500-RL96-07	
Motor	M3G112-IA	
Phase		3~
Nominal voltage	VAC	400
Nominal voltage range	VAC	380 .. 480
Frequency	Hz	50/60
Type of data definition		ml
Speed (rpm)	min <sup>-1</sup>	1350
Power input	W	1320
Current draw	A	2.1
Min. ambient temperature	°C	-25
Max. ambient temperature	°C	50

ml = Max. load · me = Max. efficiency · fa = Running at free air · cs = Customer specs · cu = Customer unit  
Subject to alterations

## Data according to ErP directive

		Actual	Request 2015			
01 Overall efficiency $\eta_{es}$	%	62.8	52.8	09 Power input $P_{ed}$	kW	1.32
02 Measurement category		A		09 Air flow $q_v$	m <sup>3</sup> /h	6130
03 Efficiency category		Static		09 Pressure increase $p_{fs}$	Pa	453
04 Efficiency grade N		72	62	10 Speed (rpm) n	min <sup>-1</sup>	1350
05 Variable speed drive		Yes		11 Specific ratio*		1.00

Data definition with optimum efficiency.  
The ErP data is determined using a motor-impeller combination in a standardised measurement configuration.

\* Specific ratio =  $1 + p_{fs} / 100\,000\text{ Pa}$

LU-152903



### Technical features

Mass	26.0 kg
Size	500 mm
Surface of rotor	Coated in black
Material of electronics housing	Die-cast aluminium
Material of impeller	PP plastic
Material of mounting plate	Sheet steel, galvanised
Material of support bracket	Steel, coated in black
Material of inlet nozzle	ABS plastic
Number of blades	7
Direction of rotation	Clockwise, seen on rotor
Type of protection	IP 55
Insulation class	"F"
Humidity (F)/environmental protection class (H)	F4-1
Note ambient temperature	Occasional start-up between -40°C and -25°C is permissible. For continuous operation at ambient temperatures below -25°C (e.g. refrigeration applications) we recommend our fan version with special low-temperature bearings.
Max. permissible ambient motor temp. (transp./ storage)	+80 °C
Min. permissible ambient motor temp. (transp./storage)	-40 °C
Mounting position	Refer to product drawing
Condensate discharge holes	Rotor-side
Operation mode	S1
Motor bearing	Ball bearing
Technical features	<ul style="list-style-type: none"> <li>- Output 10 VDC, max. 10 mA</li> <li>- Operation and alarm display</li> <li>- External 24 V input (programming)</li> <li>- Alarm relay</li> <li>- Integrated PID controller</li> <li>- Output limit</li> <li>- Motor current limit</li> <li>- PFC, passive</li> <li>- RS485 MODBUS RTU</li> <li>- Soft start</li> <li>- Maximum EEPROM write cycles 100,000</li> <li>- Control input 0-10 VDC / PWM</li> <li>- Control interface with SELV potential safely disconnected from the mains</li> <li>- Temperature derating</li> <li>- Over-temperature protected electronics / motor</li> <li>- Line undervoltage / phase failure detection</li> </ul>
EMC interference immunity	Acc. to EN 61000-6-2 (industrial environment)
EMC interference emission	Acc. to EN 61000-6-3 (household environment), except EN 61000-3-2 for professionally used devices with a total rated power greater than 1 kW
Touch current acc. IEC 60990 (measuring network Fig. 4, TN system)	<= 3.5 mA
Motor protection	Thermal overload protector (TOP) wired internally
Cable exit	Variable

K3G500-RL96-07

## EC centrifugal module - RadiCal

backward curved, single inlet

with support bracket

<b>Protection class</b>	I (if protective earth is connected by customer)
<b>Product conforming to standard</b>	EN 61800-5-1; EN 60335-1; CE
<b>Approval</b>	C22.2 Nr.77 + CAN/CSA-E60730-1; UL 1004-7 + 60730; EAC



# EC centrifugal module - RadiCal

backward curved, single inlet  
with support bracket

## Product drawing

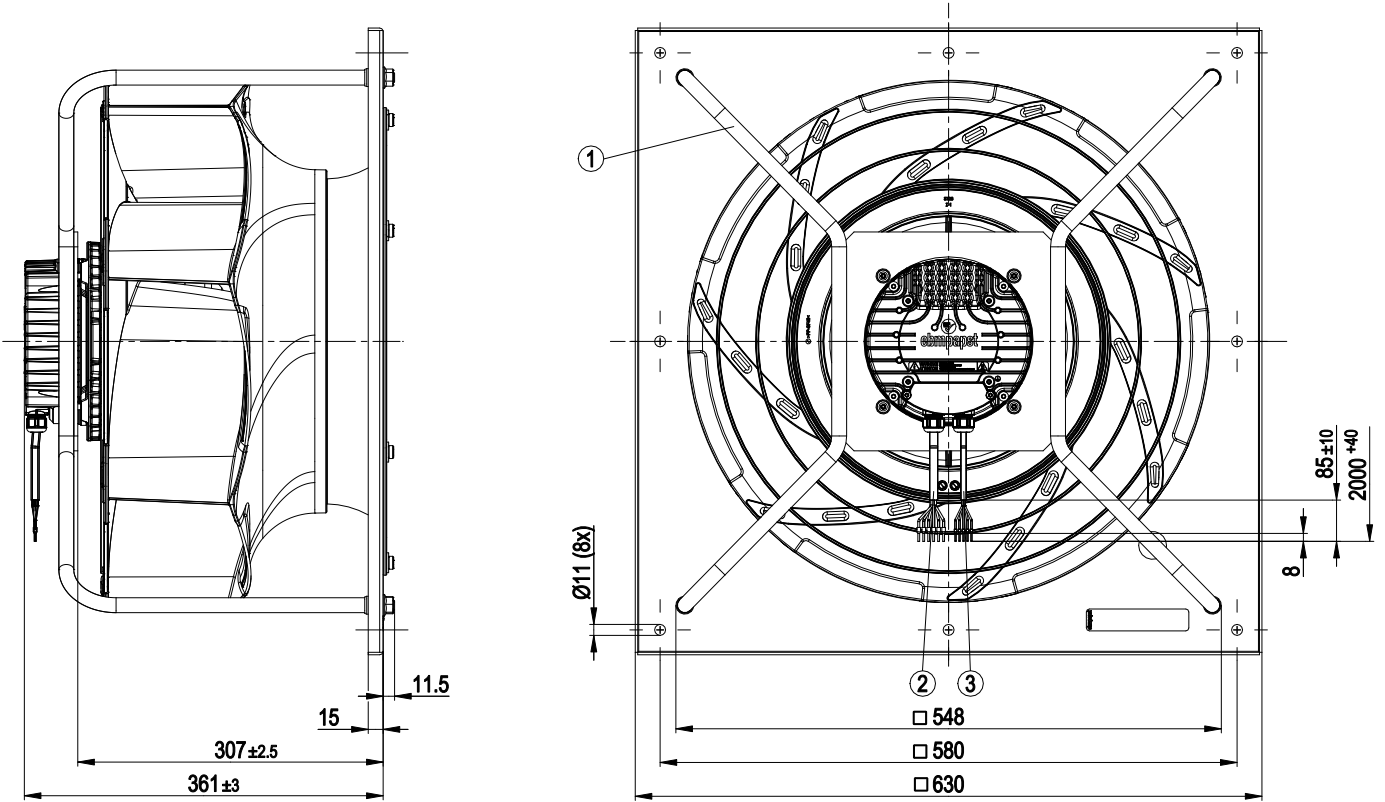

1	Installation position: shaft horizontal (install the support struts only vertically as shown in the illustration!) or rotor on bottom
2	Connection line PVC AWG18, 6x crimped core-end sleeves
3	Connection line PVC AWG22, 5x crimped core-end sleeves



# EC centrifugal module - RadiCal

backward curved, single inlet  
with support bracket

## Connection screen

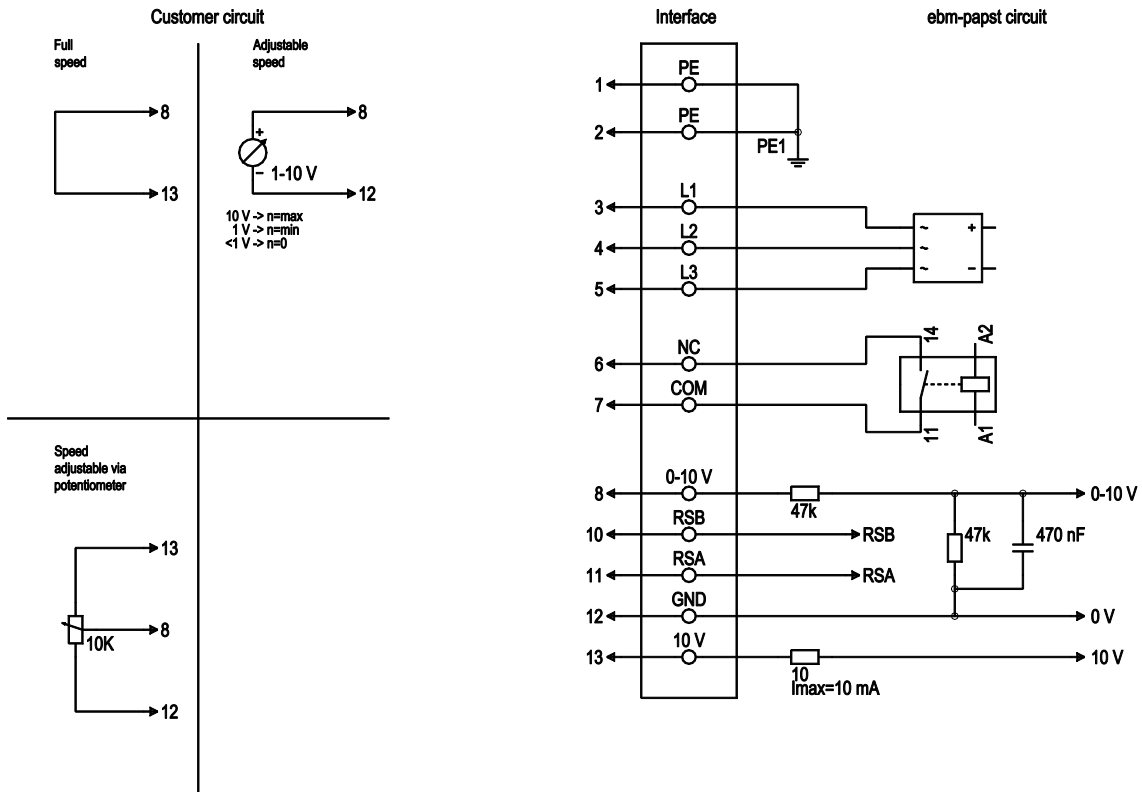

No.	Conn.	Designation	Colour	Function / assignment
1	1, 2	PE	green/yellow	Protective earth
1	3	L1	black	Power supply
1	4	L2	black	Power supply
1	5	L3	black	Power supply
1	6	NC	white 1	Status relay, floating status contact, break for failure, contact rating 250 VAC / 2 A (AC1) / min. 10 mA; reinforced insulation on mains side and basic insulation on control interface side
1	7	COM	white 2	Status relay, floating status contact, break for failure, contact rating 250 VAC / 2 A (AC1) / min. 10 mA; reinforced insulation on mains side and basic insulation on control interface side
2	8	0-10V	yellow	Analogue input (set value), 0-10 V, Ri=100 kΩ; parametrisable curve, SELV
2	10	RSB	brown	RS-485 interface for MODBUS, RSB; SELV
2	11	RSA	white	RS-485 interface for MODBUS, RSA; SELV
2	12	GND	blue	Signal ground for control interface, SELV
2	13	+10V	red	Fixed voltage output 10 VDC, +10 V ±3%, max. 10 mA, short-circuit-proof, power supply for external devices (e.g. potentiometer); SELV Fixed voltage input 24 VDC for parameter setting via MODBUS without mains power supply



# EC centrifugal module - RadiCal

backward curved, single inlet  
with support bracket

## Charts: Air flow 50 Hz

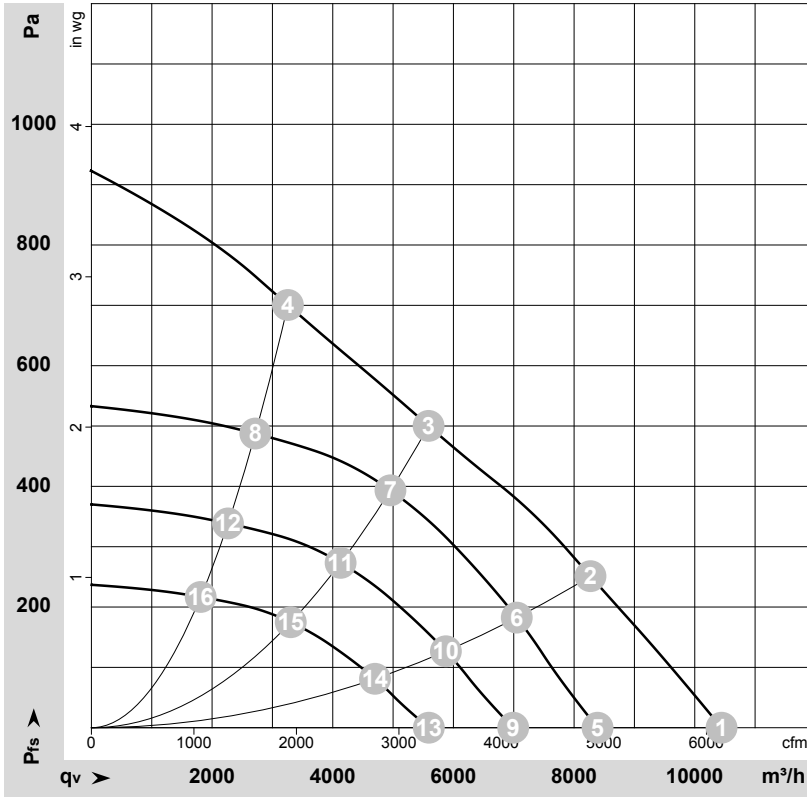

$\rho = 1.15 \text{ kg/m}^3 \pm 2 \%$

Measurement: LU-152903-1

Air performance measured as per ISO 5801 Installation category A. For detailed information on the measuring set-up, please contact ebmpapst. Suction-side noise levels: LwA measured as per ISO 13347 / LpA measured with 1m distance to fan axis. The values given are valid under the measuring conditions mentioned above and may vary according to the actual installation situation. With any deviation from the standard set-up, the specific values have to be checked and reviewed with the unit installed.

## Measured values

	U	f	n	P <sub>ed</sub>	I	LpA <sub>in</sub>	LwA <sub>in</sub>	LwA <sub>out</sub>	q <sub>v</sub>	P <sub>fs</sub>	q <sub>v</sub>	P <sub>fs</sub>
	V	Hz	min <sup>-1</sup>	W	A	dB(A)	dB(A)	dB(A)	m <sup>3</sup> /h	Pa	cfm	inH <sub>2</sub> O
1	400	50	1495	1215	1.91	74	82	88	10445	0	6145	0.00
2	400	50	1405	1320	2.10	70	77	84	8270	250	4870	1.00
3	400	50	1350	1320	2.10	64	71	78	5590	500	3290	2.01
4	400	50	1435	1300	2.05	68	77	81	3255	700	1915	2.81
5	400	50	1200	630	0.99	69	76	83	8390	0	4940	0.00
6	400	50	1200	827	1.31	66	73	80	7050	184	4150	0.74
7	400	50	1200	926	1.47	61	68	75	4955	394	2915	1.58
8	400	50	1200	761	1.20	64	72	77	2715	488	1600	1.96
9	400	50	1000	364	0.57	64	72	78	6990	0	4115	0.00
10	400	50	1000	478	0.76	61	68	75	5875	128	3460	0.51
11	400	50	1000	536	0.85	56	63	70	4130	273	2430	1.10
12	400	50	1000	441	0.69	59	68	72	2265	339	1335	1.36
13	400	50	800	187	0.29	59	66	72	5595	0	3290	0.00
14	400	50	800	245	0.39	55	63	69	4700	82	2765	0.33
15	400	50	800	274	0.44	50	58	64	3305	175	1945	0.70
16	400	50	800	226	0.36	54	62	67	1810	217	1065	0.87

U = Supply voltage · f = Frequency · n = Speed (rpm) · P<sub>ed</sub> = Power input · I = Current draw · LpA<sub>in</sub> = Sound pressure level inlet side · LwA<sub>in</sub> = Sound power level inlet side · LwA<sub>out</sub> = Sound power level outlet side  
q<sub>v</sub> = Air flow · p<sub>fs</sub> = Pressure increase

