

# AC centrifugal fan

backward curved, single inlet  
with housing and angle bracket

G2E150-DK82-19 ebmpapst Datasheet  
sales@fansco.com  
www.fansco.com

Limited partnership · Headquarters Muldingen  
County court Stuttgart · HRA 590344

General partner Elektrobau Muldingen GmbH · Headquarters Muldingen  
County court Stuttgart · HRB 590142

## Nominal data

Type	G2E150-DK82-19	
Motor	M2E068-CF	
Phase		1~
Nominal voltage	VAC	230
Frequency	Hz	50
Type of data definition		fa
Valid for approval / standard		CE
Speed (rpm)	min <sup>-1</sup>	2800
Power input	W	41
Current draw	A	0.25
Motor capacitor	µF	1
Capacitor voltage	VDB	400
Capacitor standard		S0 (CE)
Min. back pressure	Pa	0
Min. ambient temperature	°C	-25
Max. ambient temperature	°C	90
Starting current	A	0.62

ml = Max. load · me = Max. efficiency · fa = Running at free air · cs = Customer specs · cu = Customer unit  
Subject to alterations



# AC centrifugal fan

backward curved, single inlet  
with housing and angle bracket

## Technical features

<b>Mass</b>	3 kg
<b>Size</b>	150 mm
<b>Surface of rotor</b>	Uncoated
<b>Material of impeller</b>	Sheet steel, rust and acid-resistant
<b>Housing material</b>	Aluminium sheet
<b>Number of blades</b>	6
<b>Motor suspension</b>	Motor anti-vibration mounted on one side via mounting plate
<b>Direction of rotation</b>	Counter-clockwise, seen on rotor
<b>Type of protection</b>	IP 44
<b>Insulation class</b>	"F"
<b>Humidity (F)/environmental protection class (H)</b>	H0 - dry environment
<b>Max. permissible ambient motor temp. (transp./ storage)</b>	+ 80 °C
<b>Min. permissible ambient motor temp. (transp./storage)</b>	- 40 °C
<b>Mounting position</b>	Any
<b>Condensate discharge holes</b>	None
<b>Operation mode</b>	S1
<b>Motor bearing</b>	Ball bearing
<b>Touch current acc. IEC 60990 (measuring network Fig. 4, TN system)</b>	< 0.75 mA
<b>Electrical leads</b>	Capacitor mounted
<b>Motor protection</b>	Thermal overload protector (TOP) wired internally
<b>Cable exit</b>	Variable
<b>Protection class</b>	I (if protective earth is connected by customer)
<b>Motor capacitor according to EN 60252-1 in safety protection class</b>	S2
<b>Product conforming to standard</b>	EN 60335-1; CE



# AC centrifugal fan

backward curved, single inlet  
with housing and angle bracket

## Product drawing

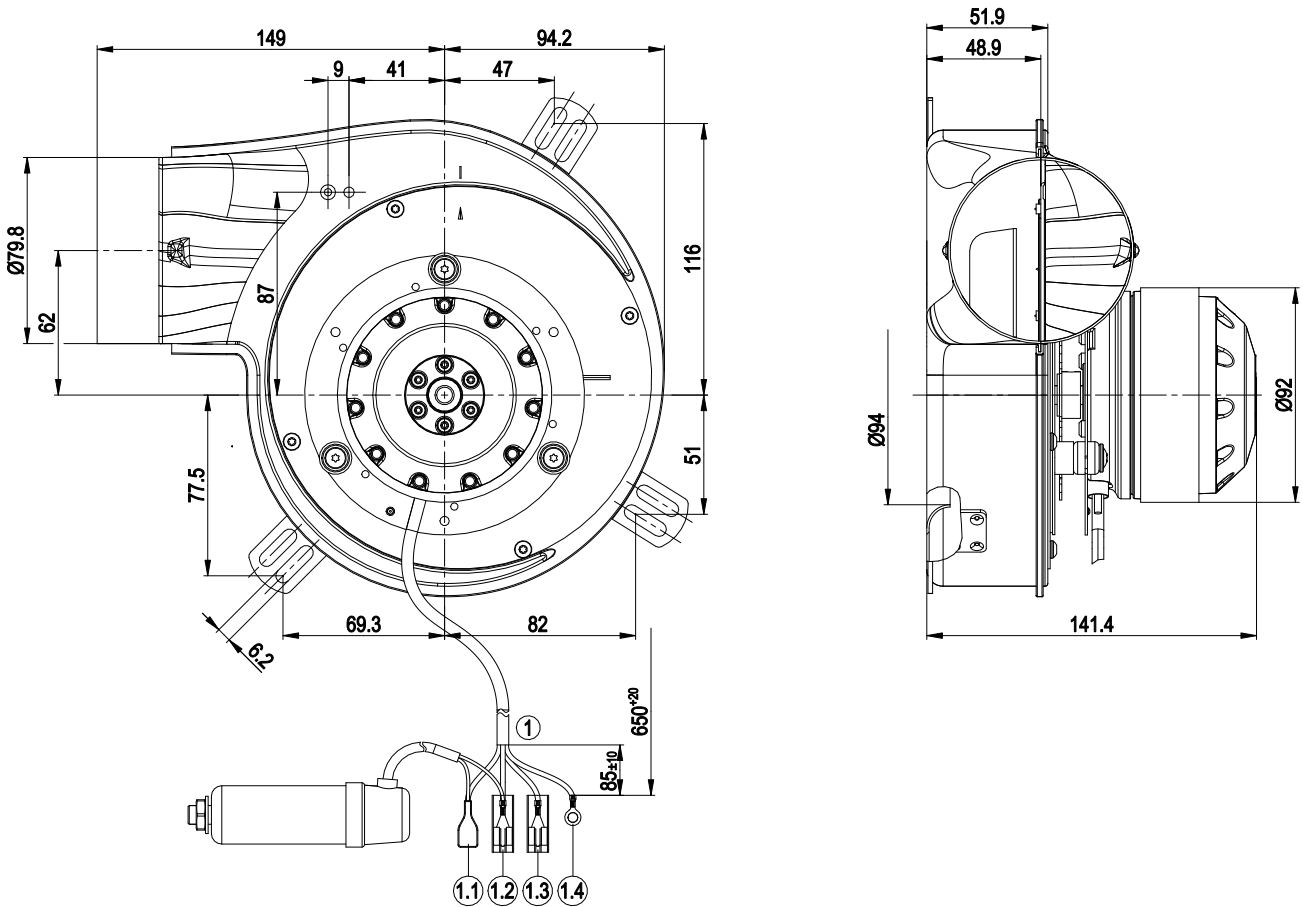

1	Connection line silicone 4G 0.5 mm <sup>2</sup>
1.1	(brown + capacitor), threaded pin 6.3x0.8 insulated with heat shrink tube
1.2	L (black + capacitor), threaded pin 6.3x0.8 with connector housing
2.3	N (blue), threaded pin 6.3x0.8 with connector housing
2.4	PE (green/yellow), contact stud Ø 4.3
-	Comment: equipped with shaft seal



# AC centrifugal fan

backward curved, single inlet  
with housing and angle bracket

## Connection screen

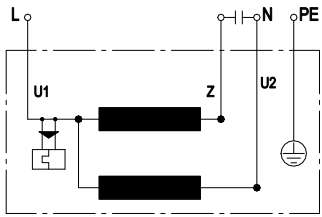

U1	blue	Z	brown	U2	black
PE	green/yellow				



# AC centrifugal fan

backward curved, single inlet  
with housing and angle bracket

## Charts: Air flow 50 Hz

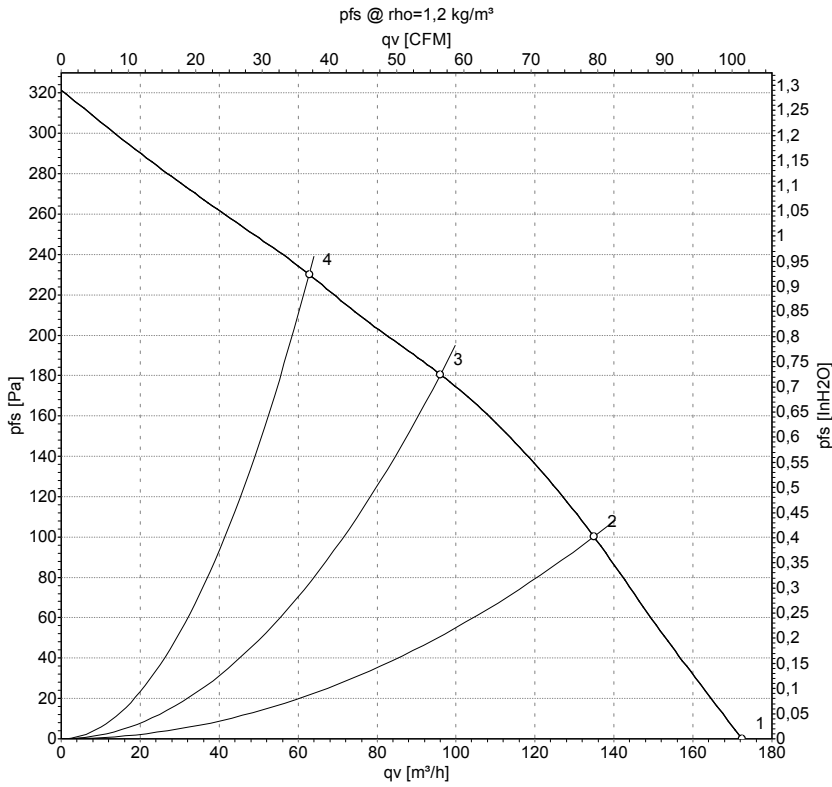

Measurement: LU-136512-1

Air performance measured as per ISO 5801 Installation category A. For detailed information on the measuring set-up, please contact ebm-papst. Suction-side noise levels: LwA measured as per ISO 13347 / LpA measured with 1m distance to fan axis. The values given are valid under the measuring conditions mentioned above and may vary according to the actual installation situation. With any deviation from the standard set-up, the specific values have to be checked and reviewed with the unit installed.

## Measured values

	U	f	n	P <sub>e</sub>	I	LpA <sub>in</sub>	LwA <sub>in</sub>	q <sub>v</sub>	p <sub>fs</sub>	q <sub>v</sub>	p <sub>fs</sub>
	V	Hz	min <sup>-1</sup>	W	A	dB(A)	dB(A)	m³/h	Pa	cfm	inH2O
1	230	50	2800	41	0.25	63	70	170	0	100	0.00
2	230	50	2805	40	0.25	61	67	135	100	80	0.40
3	230	50	2820	39	0.25	57	64	95	180	55	0.72
4	230	50	2845	37	0.25	55	64	65	230	35	0.92

U = Supply voltage · f = Frequency · n = Speed (rpm) · P<sub>e</sub> = Power input · I = Current draw · LpA<sub>in</sub> = Sound pressure level inlet side · LwA<sub>in</sub> = Sound power level inlet side · q<sub>v</sub> = Air flow  
p<sub>fs</sub> = Pressure increase

