

D2E146-AP47-D3

AC centrifugal fan

forward-curved, dual-intake
with housing (flange)



D2E146-AP47-D3 ebmpapst Datasheet
sales@fansco.com
www.fansco.com

Nominal data

Type	D2E146-AP47-D3	
Motor	M2E068-EC	
Phase		1~
Nominal voltage	VAC	230
Frequency	Hz	50
Method of obtaining data		ce
Valid for approval/standard		-
Speed (rpm)	min ⁻¹	1950
Power consumption	W	310
Current draw	A	1.36
Capacitor	μF	8
Capacitor voltage	VDB	400
Capacitor standard		S0 (CE)
Min. back pressure	Pa	165
Min. back pressure	in. wg	0.66
Min. ambient temperature	°C	-25
Max. ambient temperature	°C	35

ml = Max. load · me = Max. efficiency · fa = Free air · cs = Customer specification · ce = Customer equipment
Subject to change



AC centrifugal fan

forward-curved, dual-intake

with housing (flange)

Technical description

Weight	4.36 kg
Size	146 mm
Motor size	68
Rotor surface	Unpainted
Impeller material	Sheet steel, galvanized
Housing material	Sheet steel, galvanized
Motor suspension	Motor mounted with brackets on one side
Direction of rotation	Counterclockwise, viewed toward rotor
Degree of protection	IP44; installation- and position-dependent as per EN 60034-5
Insulation class	"F"
Moisture (F) / Environmental (H) protection class	H0 - dry environment
Max. permitted ambient temp. for motor (transport/storage)	+ 80 °C
Min. permitted ambient temp. for motor (transport/storage)	- 40 °C
Installation position	Shaft horizontal or rotor on bottom; rotor on top on request
Condensation drainage holes	On rotor side
Mode	S1
Motor mounting	Ball bearing
Touch current according to IEC 60990 (measuring circuit Fig. 4, TN system)	< 0.75 mA
Electrical hookup	Plug; Capacitor mounted
Motor protection	Thermal overload protector (TOP) with basic insulation
With cable	Axial
Protection class	I (with customer connection of protective earth)
Motor capacitor according to EN 60252-1 in safety protection class	S0
Conformity with standards	EN 60335-1



AC centrifugal fan

forward-curved, dual-intake
with housing (flange)

Product drawing

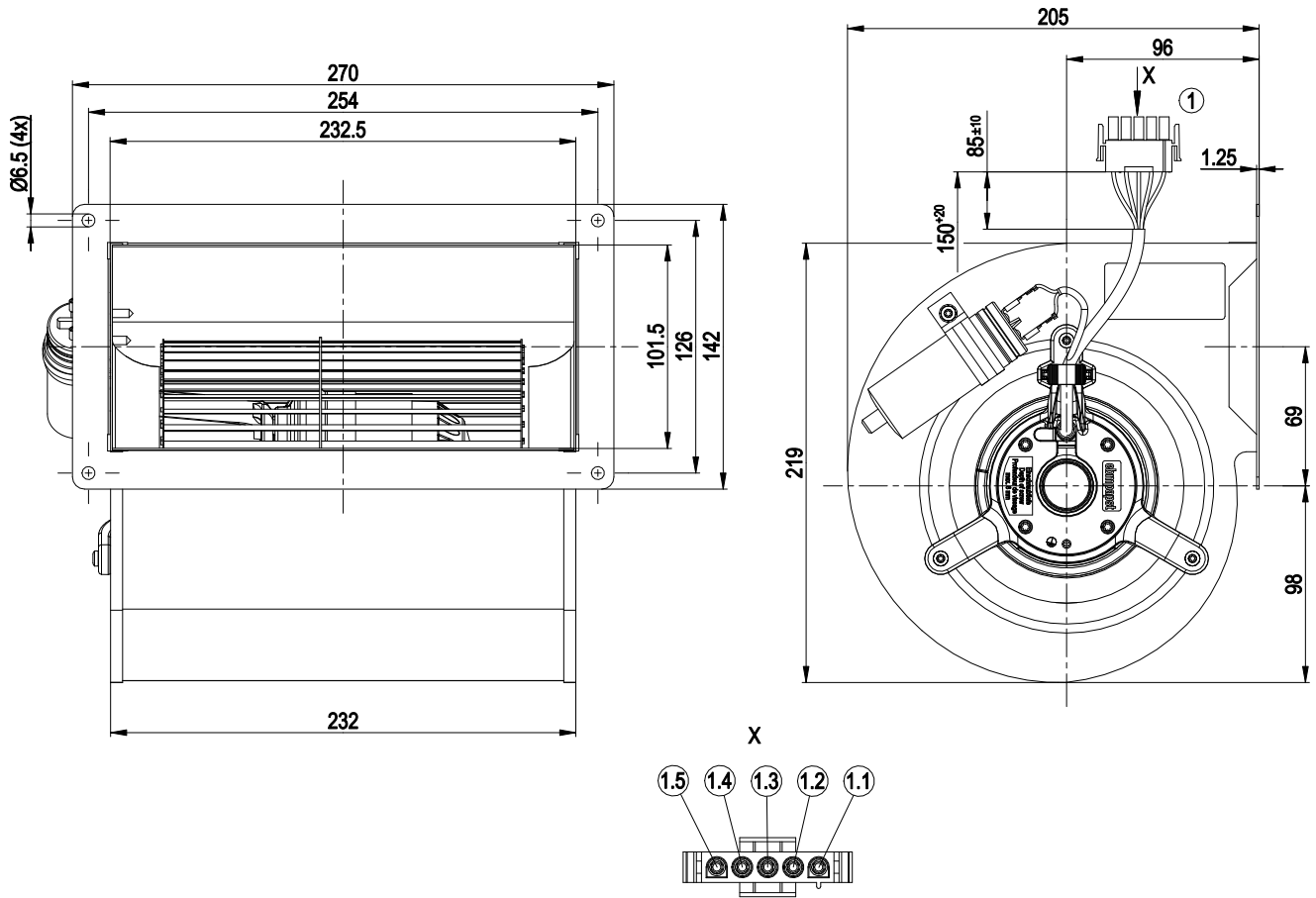

1	Cable halogen-silicone-free 5x 0.5 mm ² , 5-pole connector housing tyco 350809-3, 5x crimped plug pin tyco 926885-1
1.1	blue
1.2	black
1.3	green/yellow
1.4	gray
1.5	gray



D2E146-AP47-D3

AC centrifugal fan

forward-curved, dual-intake
with housing (flange)

Connection diagram

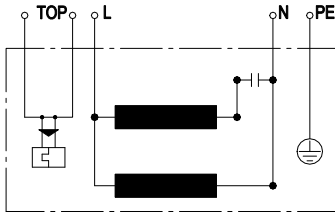

L	blue	N	black	PE	green/yellow
TOP	2x gray				



AC centrifugal fan

forward-curved, dual-intake

with housing (flange)

Curves: Air performance 50 Hz Y

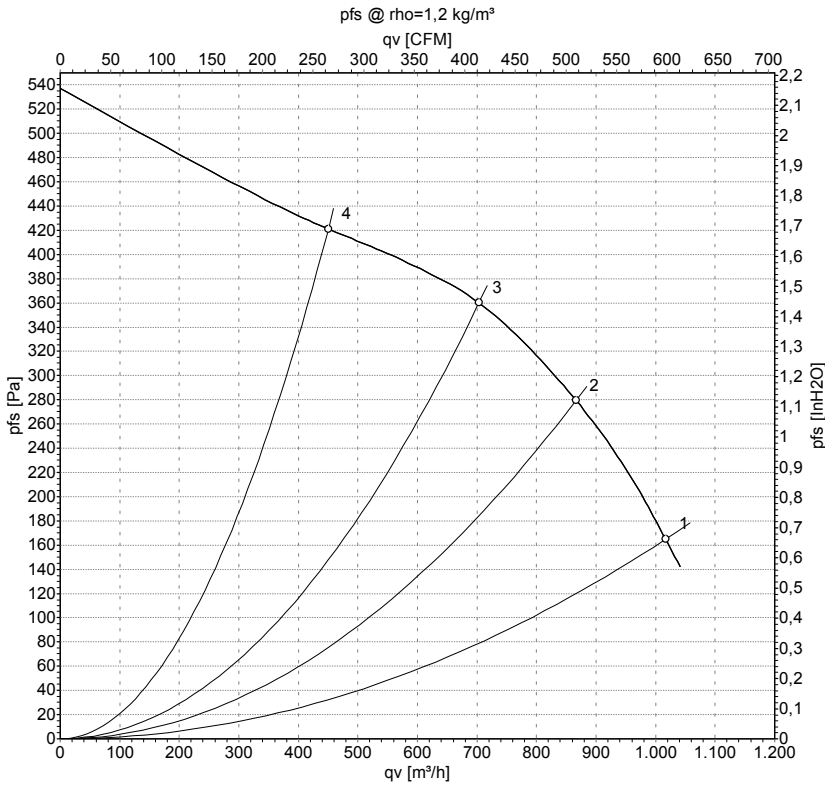

Measurement: LU-32744-1

Air performance measured according to ISO 5801 installation category A. For detailed information on the measurement setup, contact ebm-papst. Intake sound level: Sound power level according to ISO 13347 / sound pressure level measured at 1 m distance from fan axis. The values given are valid under the specified measuring conditions and may vary due to conditions of installation. For deviations from the standard configuration, the parameters have to be checked on the installed unit.

Measured values

	Wired	U	f	n	P _e	I	q _v	P _{fs}	q _v	P _{fs}
		V	Hz	min ⁻¹	W	A	m ³ /h	Pa	cfm	in. wg
1	Y	230	50	1950	310	1.36	1015	165	600	0.66
2	Y	230	50	2215	275	1.21	865	280	510	1.12
3	Y	230	50	2435	242	1.06	705	360	415	1.45
4	Y	230	50	2625	203	0.89	450	420	265	1.69

Wired = Wiring · U = Power supply · f = Frequency · n = Speed (rpm) · P_e = Power consumption · I = Current draw · q_v = Air flow · p_{fs} = Pressure increase

