

AC centrifugal fan

forward curved, dual inlet

with housing (without flange), for railway applications

D2D146-BE03-19 ebmpapst Datasheet

sales@fansco.com

www.fansco.com

Limited partnership · Headquarters Muldingen
County court Stuttgart · HRA 590344General partner Elektrobau Muldingen GmbH · Headquarters Muldingen
County court Stuttgart · HRB 590142

Nominal data

Type	D2D146-BE03-19	
Motor	M2D068-EC	
Phase		3~
Nominal voltage	VAC	400
Connection		Y
Frequency	Hz	50
Type of data definition		ml
Valid for approval / standard		CE
Speed (rpm)	min ⁻¹	1570
Power input	W	195
Current draw	A	0.3
Min. back pressure	Pa	100
Min. ambient temperature	°C	-25
Max. ambient temperature	°C	60
Starting current	A	0.46

ml = Max. load · me = Max. efficiency · fa = Running at free air · cs = Customer specs · cu = Customer unit
Subject to alterations

AC centrifugal fan

forward curved, dual inlet

with housing (without flange), for railway applications

Technical features

Mass	4.34 kg
Size	146 mm
Motor size	68
Surface of rotor	Coated in black
Material of impeller	Sheet steel, galvanised and coated in black
Housing material	Sheet steel, galvanised
Direction of rotation	Counter-clockwise, seen on rotor
Type of protection	IP55
Insulation class	"F"
Humidity (F) / environmental protection class (H)	H1
Max. permissible ambient motor temp. (transp./ storage)	+80 °C
Min. permissible ambient motor temp. (transp./storage)	-40 °C
Mounting position	Any
Condensation drainage holes	None
Operation mode	S1
Motor bearing	Hybrid bearing
Touch current acc. IEC 60990 (measuring network Fig. 4, TN system)	< 0.75 mA
Motor protection	Thermal overload protector (TOP) brought out, basic insulation
Cable exit	Axial
Protection class	I (if protective earth is connected by customer)
Approval	EAC
Remark	Prerequisite for operation is a Class 1 vehicle electrical system architecture according to EN 50533



AC centrifugal fan

forward curved, dual inlet

with housing (without flange), for railway applications

Product drawing

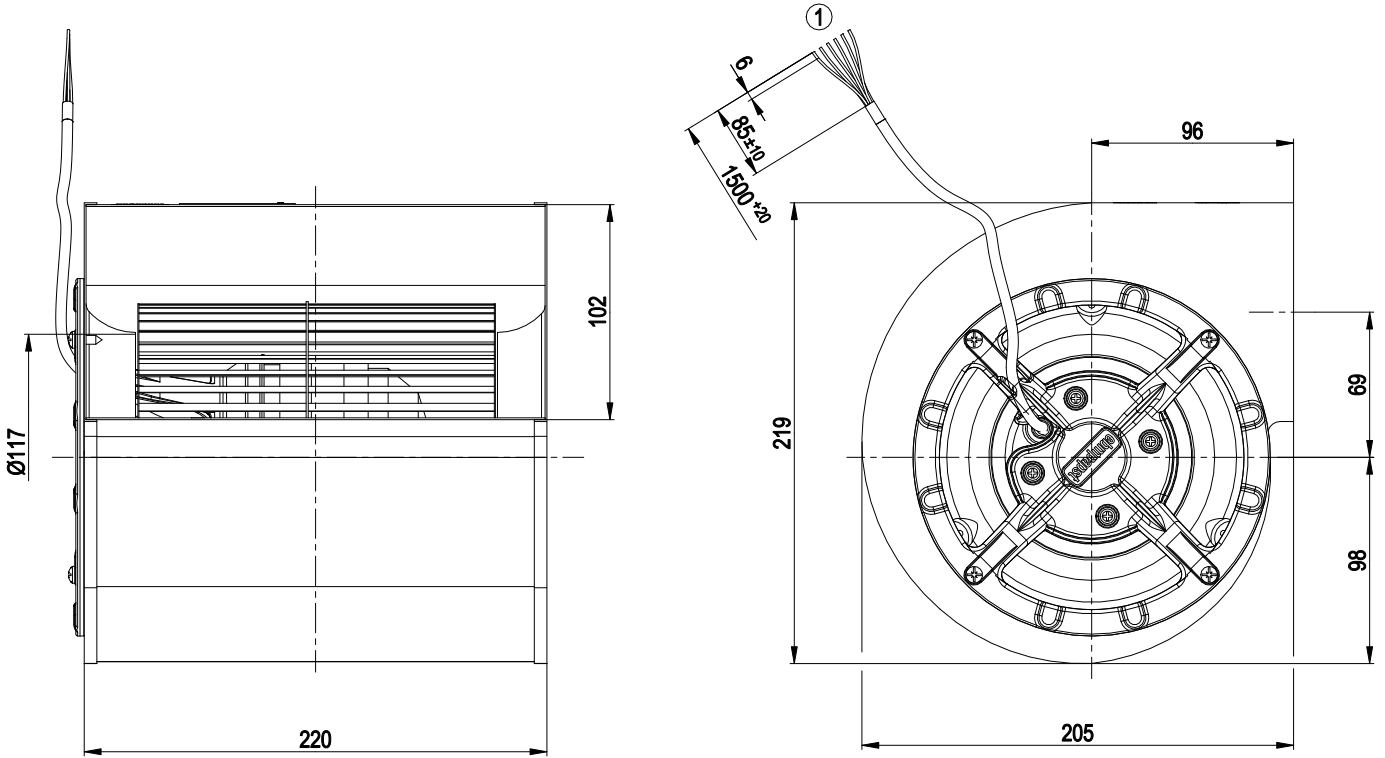

1	Connection line, halogen-free, railway application EN 45545, 6G 0.5 mm ² 6x lead tip
---	--



AC centrifugal fan

forward curved, dual inlet

with housing (without flange), for railway applications

Connection screen

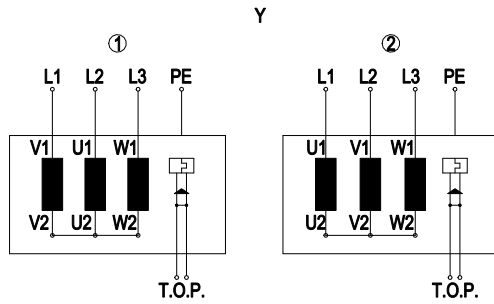

Y	Star connection, three-phase motor
1	Counter-clockwise operation
L1	blue
L2	black
L3	brown
PE	green/yellow
TOP	grey
2	Clockwise operation
L1	black
L2	blue
L3	brown
PE	green/yellow
TOP	grey



AC centrifugal fan

forward curved, dual inlet

with housing (without flange), for railway applications

Charts: Air flow 50 Hz

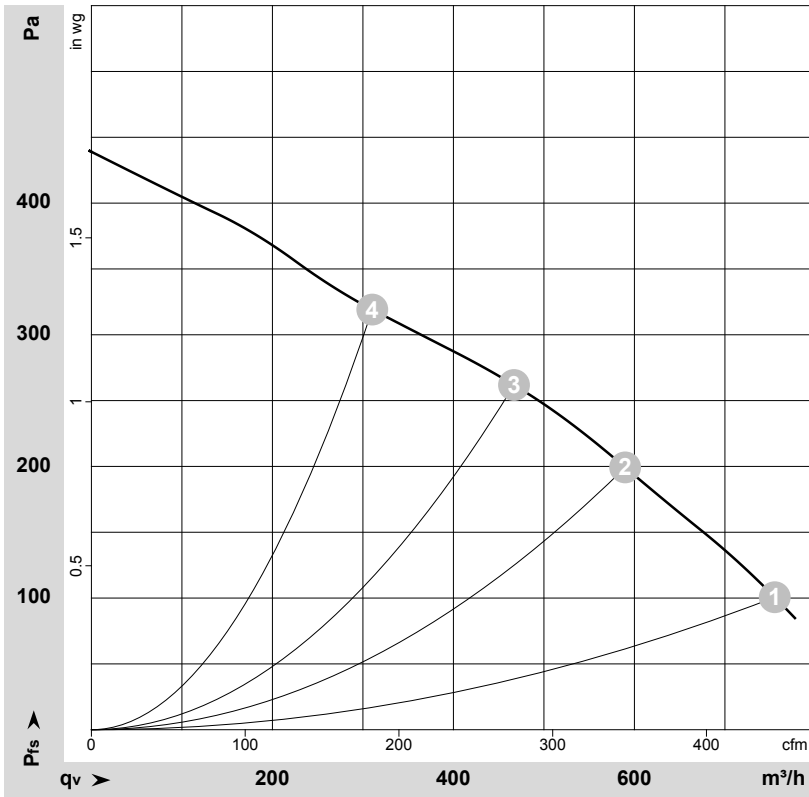

$\rho = 1.15 \text{ kg/m}^3 \pm 2 \%$

Measurement: LU-171333-1

Air performance measured as per ISO 5801 Installation category A. For detailed information on the measuring set-up, please contact ebmpapst. Suction-side noise levels: LwA measured as per ISO 13347 / LpA measured with 1m distance to fan axis. The values given are valid under the measuring conditions mentioned above and may vary according to the actual installation situation. With any deviation from the standard set-up, the specific values have to be checked and reviewed with the unit installed.

Measured values

	Conn.	U	f	n	P _e	I	LpA _{in}	LwA _{in}	q _v	P _{fs}	q _v	P _{fs}
		V	Hz	min ⁻¹	W	A	dB(A)	dB(A)	m ³ /h	Pa	cfm	in. wg
1	Δ	400	50	1570	195	0.30	56	67	755	100	445	0.40
2	Δ	400	50	1885	164	0.24	56	67	590	200	345	0.80
3	Δ	400	50	2115	139	0.21	59	69	465	260	275	1.04
4	Δ	400	50	2310	116	0.18	61	71	310	320	180	1.28

Conn. = Connection · U = Supply voltage · f = Frequency · n = Speed (rpm) · P_e = Power input · I = Current draw · LpA_{in} = Sound pressure level inlet side · LwA_{in} = Sound power level inlet side
 q_v = Air flow · p_{fs} = Pressure increase

